

# Tanzania: The Great Migration Safari



Wilderness Travel



## TRIP DATES

### 2024

December 22, 2024-January 3, 2025

### 2025

January 30-February 11, 2025

February 23-March 7, 2025

March 18-30, 2025

June 10-22, 2025

July 6-18, 2025

July 28-August 9, 2025

August 18-30, 2025

September 8-20, 2025

September 22-October 4, 2025

December 22, 2025-January 3, 2026

### 2026

January 12-24, 2026

February 6-18, 2026

February 27-March 11, 2026

March 15-27, 2026

June 14-26, 2026

July 5-17, 2026

July 26-August 7, 2026

August 16-28, 2026

September 6-18, 2026

September 27-October 9, 2026

# Tanzania: The Great Migration Safari

Tanzania is home to the planet's most varied menagerie of terrestrial wildlife. From the Serengeti, whose name means "endless plains" in Maasai, to the year-round concentrations of big game in Tarangire National Park, Tanzania is justifiably known as the greatest safari destination on Earth, with a third of its land dedicated to protected wildlife areas. There are limitless game viewing possibilities here—and by investing the time to get off the beaten path, our groups have the best opportunities for stunning animal encounters. From exclusive camps in gorgeous locations selected for privacy and unparalleled access to the migrating herds, you will enjoy exciting bush walks, night game drives, off-road travel, and cultural encounters with the Maasai. Our masterful trip leaders, who have an eye for spotting even the most elusive animals, will bring you on game drives to secluded areas, far from the safari crowds. Picture yourself, after a day in the stunning wildlife amphitheater of Ngorongoro Crater or among the elephant herds in Tarangire National Park, taking a sunset walk topped by a glass of champagne, and relaxing by the campfire with a billion stars overhead and the sounds of the bush in the distance. This is the way safari was meant to be.

# What Makes WT's Serengeti Safari Special?



## EXCLUSIVE LUXURY CAMPS IN IDEAL LOCATIONS FOR GAME VIEWING

Our seasonally adjusted itineraries, perfected over nearly four decades, are designed to get you right into the heart of the Great Migration no matter what time of year you go. We get you away from the lodge circuit and its crowds—and what a difference that makes! You'll enjoy luxurious camps that are for our groups alone. And though it may be called camping, the experience is more like a dream hotel.

## COMFORTABLE VEHICLES, SPECIALLY DESIGNED FOR SAFARI

We'll travel for most of the trip in custom-designed Land Cruisers that guarantee each passenger has their own window seat and ample room to stretch out—both your legs and your camera gear! Rather than use crowded pop-top minibuses that can't go off-road, we use rugged extended cab 4x4s with three rows of seats for only 5 passengers and a separate roof hatch for each row of seats. This allows you delightful personal space with unobstructed views and an ideal vantage for getting great photos.

## A VARIETY OF ACTIVITIES

In addition to our phenomenal daily game drives, we've woven a variety of other activities into the experience, from off-road travel in our sturdy 4x4s to exciting game walks, night drives, fascinating cultural encounters with the Maasai, a visit to Mary Leakey's Olduvai Gorge, a day in the legendary Ngorongoro Crater, and a private charter flight that avoids a long drive and offers the likely chance of spectacular aerial views of the Great Migration.

## EXPERT LEADERS WHO STAY WITH YOU THROUGHOUT

With a maximum of 15 adventurers per departure, our small group size ensures that you never feel crowded or rushed. Our expert Trip Leader and assistant naturalist guides accompany you throughout the entire safari—you aren't handed off to different guides as you often are on a lodge-based safari.

## TARANGIRE! THIS HIDDEN GEM OFFERS THE LAST TRUE LUXURY IN TRAVEL: EXCLUSIVITY

While the Serengeti and Ngorongoro Crater are Tanzania's big draws, one of its most fantastic hidden gems is Tarangire National Park, especially its remote southern end, where our delightful camp is located. Enormous herds of elephants and buffalo await, along with excellent leopard sightings, the chance to do night drives, bush walks—all of which are not possible in the Serengeti or Ngorongoro—as well as fascinating visits to still very traditional Maasai villages, and best of all you'll feel as if you have all of Africa to yourself!

# The Serengeti Migration

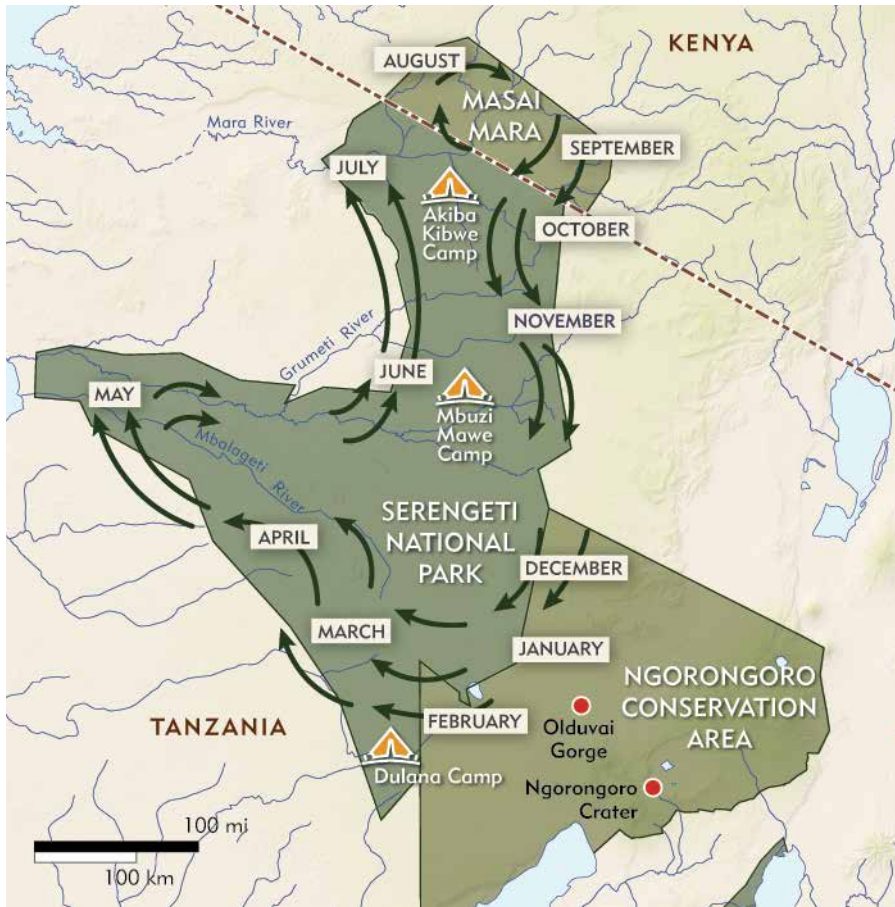

## WHAT IS THE GREAT MIGRATION?

The Great Migration is the largest mass movement of land mammals on Earth, when more than a million wildebeest—along with hundreds of thousands of zebra and gazelle, stalked by predators like big cats and hyenas—circle through the Serengeti plains in Tanzania and Masai Mara Reserve in Kenya. Following instinct and the scent of moisture, the herds move clockwise from their calving grounds in the lush plains of the southern Serengeti, moving to the northern Serengeti as the plains dry out, and spending the summer and early fall here before heading south again in the fall to repeat the cycle. The scale of this event, and the encounters between predator and prey, offer an extraordinary and unequalled wildlife spectacle. Witnessing it firsthand is an awe-inspiring privilege.



# When is the Best Time to See it?

The short answer is that you can't go wrong, because the migration never truly stops. Whenever you choose to go, the wildlife experiences are always extraordinary. We move our Serengeti camps seasonally to follow the herds, giving you access to world-class game viewing on every departure. Wilderness Travel offers Serengeti safaris in two seasons: from December through March, when the migration is in the south and the wildebeest give birth and nurture their calves, and from June through October, when the herds mass at the northern end of the park, preparing to cross the Mara River into Kenya.

## SOUTHERN SERENGETI: DECEMBER THROUGH MARCH



DAY	ITINERARY IN BRIEF
Day 1	Arusha
Day 2-5	Tarangire National Park, Osunyai Lamarkau Camp
Day 6-8	Ngorongoro Crater / Cultural visit with the Datoga and Hadza
Day 9-12	Olduvai Gorge / Dulana Camp, Serengeti National Park
Day 13	Arusha

More than two million years ago, volcanic eruptions spewed ash and debris onto the southern Serengeti plains, enriching the surrounding soil. As a result, lush grasses grow here in the green season—making it the perfect feeding ground for pregnant wildebeest to graze and produce nutrient-dense milk. Over a period of just a few weeks, females give birth to more than 300,000 calves; the presence of these wobbly-kneed newborns draws predators like big cats and hyena.

Our Dulana Camp sits near their migratory route, where columns of wildebeest can be seen stretching for miles, sometimes passing right by the camp itself! This is also an excellent time of year for bird-watching, as there is an abundance of migratory flocks passing over the plains.

## CENTRAL & NORTHERN SERENGETI: JUNE THROUGH OCTOBER



DAY	ITINERARY IN BRIEF
Day 1	Arusha
Day 2-5	Tarangire National Park, Osunyai Lamarkau Camp
Day 6-8	Ngorongoro Crater / Cultural visit with the Datoga and Hadza
Day 9-12	Olduvai Gorge (June) / Serengeti National Park, Akiba Kibwe Camp (including Mbuzi Mawe Tented Camp on the June departure)
Day 13	Arusha

By this season, the herds will be in the northwest, having made their way from the western corridor of the park, and by June arriving at the Grumeti River, which now runs low and teems with opportunistic Nile crocodile. As the main body of the herd continues north over the summer months, wildebeest mass on the banks of the Mara River in incredible numbers before the hardest single part of their long journey: a dramatic, life-or-death river crossing into Kenya.

This is one of the greatest wildlife shows on Earth. In the northern Serengeti, we stay at Akiba Kibwe Camp, ideally positioned by the Mara River. We spend several days here, giving us a great chance of witnessing the dramatic river crossings made so famous in many wildlife documentaries. June is a transition month for the migration, so on that departure we spend two nights at a tented camp in the central Serengeti before heading north to Akiba Kibwe.

# Tanzania: The Great Migration Itinerary

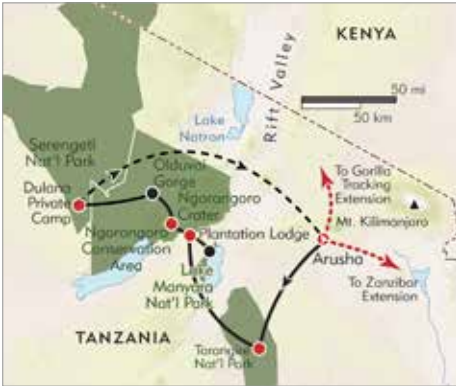

## DAY 1 ARRIVE IN ARUSHA, TANZANIA

Late evening arrival at Kilimanjaro Airport near Arusha. Trip members arriving on Day 1 are met and transferred to our accommodation, the Olerai Guesthouse, set in a tranquil garden shaded by acacia trees. We have a light dinner and overnight at the lodge...D

## DAY 2 TARANGIRE NATIONAL PARK / WILDERNESS TRAVEL'S PRIVATE OSUNYAI LAMARKAU CAMP

We depart for Tarangire, with a game drive and picnic lunch en route to our private camp in Osunyai, on the edge of the wilderness zone close to the Silalie wetland and prime habitat for elephant and buffalo. Set beneath glorious mature acacia trees facing the rising sun, our private camp at Osunyai has a classic bush camp backdrop in the heart of big game country. Overnight at private Wilderness Travel camp at Osunyai Lamarkau...BLD

## TRIP DETAILS AT-A-GLANCE

- Length:** 13 days
- Arrive:** Arusha, Tanzania
- Depart:** Arusha, Tanzania
- Lodging:** 4 nights deluxe game lodges, 8 nights exclusive private camps
- Meals:** All meals included (B=Breakfast, L=Lunch, D=Dinner)
- Activity:** Cultural Adventures, Safaris, Wildlife and Natural History
- Trip Level:** 1 2 3 4 5 6  
4WD game viewing, optional guided game walks, evening game drives

## DAYS 3-5 TARANGIRE NATIONAL PARK / WILDERNESS TRAVEL'S OSUNYAI LAMARKAU CAMP

Tarangire's grasslands and wooded bush country are home to enormous herds of elephant and migrating plains game. In addition to the large numbers of animals, the sheer variety of species seen in Tarangire continues to be one of its attractions. The short rains of November and December enrich Tarangire's grasslands, creating a canvas so green it almost defies description. At this time of year, bird species flood into Tarangire from southern Europe as they migrate for the winter, boosting an already full bird list. During the rainless summer months, the thousand-square-mile Tarangire region is a magnet for migrating herds, as the perennial Tarangire River becomes a lifeline for migratory herds of wildebeest and zebra, who travel to reach its fresh waters. It is astounding to see the tremendous seasonal concentrations: elephant clustered in the hundreds, huge herds of zebra, wildebeest, buffalo, eland,



and impala, smaller groups of oryx, kongoni, and Grant's gazelle and troops of baboon. Cheetah are rare here, but this is good habitat for leopard that can often be found resting in trees. Lion can be seen along the river or under trees, enjoying this dry-season time of bounty. Tarangire is also famous for its abundant birdlife.

Special wildlife viewing activities include exploration in open vehicles with a 360-degree game viewing panorama (green season only—at other times of the year, we use our regular Toyota Land Cruisers). We also take exciting bush walks, exploring in the company of one of our full-time walking guides stationed at our Osunyai wilderness camp and qualified in all aspects of true game walking. Our specialist walking guide has extensive knowledge of wild animal behavior and the ability to track any animal of interest that we encounter during the walk. Feeling adventurous? You'll also have the option of an overnight stay in a "fly camp." Overnights at private Wilderness Travel camp at Osunyai Lamarkau...BLD

#### DAYS 6-8 PLANTATION LODGE / NGORONGORO SERENA SAFARI LODGE / MBUZI MAWE / DATOGA CULTURAL VISIT / NGORONGORO CRATER

For the next three days, we will overnight at Plantation Lodge,

a small, elegant lodge surrounded by coffee plantations near Karatu in the Ngorongoro Conservation Area, Ngorongoro Serena Safari Lodge, set on the Ngorongoro Crater rim at a cool 6,000 feet, and Mbuzi Mawe Tented Camp in the central Serengeti. We enjoy game drives en route to our lodges and have some time to relax and enjoy the surroundings of our accommodations.

*"What an exceptional itinerary, safari, and camping experience! The volume of animals is extraordinary and our guides did a great job of finding things that few others would find. I'll never forget how moving seeing these animals in their natural habitat was. The bush camps were exceptional—brings new meaning to 'glamping!' Being able to stay in the bush in comfort really magnified the overall excellence of the safari."*

*Steve S., San Francisco, CA*

On one of these days, we spend the day on a game drive on the floor of Ngorongoro Crater, the largest unbroken caldera in the world and surrounded by steep walls rising some 2,000 feet from the floor. Ngorongoro's beauty and vastness must be seen to be believed: on the crater's 105-square-mile grassy floor lives Africa's largest permanent concentration of wildlife, a sort of mini-

Serengeti in a phenomenally scenic setting. During our explorations, we're likely to see elephant, zebra, wildebeest, and buffalo, and there's hardly a better place on earth for observing lion than on the crater floor, where the lion prides are large. This is also one of the best places to see the endangered black rhino—about a dozen have been introduced into the crater environment and they are carefully monitored by biologists.

While in the area, we will also have the experience of a cultural visit with the Datoga and Hadza. The Datoga consider





themselves to be the oldest tribe in Tanzania, with origins dating back 3,000 years. They gradually migrated south from southern Sudan and Ethiopia and settled in the highlands of Kenya and Tanzania in about AD 1500. Originally fierce warriors, they are now mostly pastoralists and farmers, as well as skilled blacksmiths. Their clothing is generally of a reddish-brown color (the color of soil), with women wearing patched leather dresses, and they are distinguished for their distinctive tattooing around the eyes. The Hadza (who call themselves the Hadzabe) are one of the last hunter-gatherer tribes left in the world and distinct from other tribes in East Africa, both linguistically and genetically. Their diet consists of wild honey, tubers, berries, baobab, and large and small game. Overnights at Plantation Lodge, Ngorongoro Serena Lodge, and Mbuli Mawe (see below)...BLD each day

Note: Our specific activities and overnight lodgings on Days 6-8 vary with each departure, but you will experience it all, just in a different sequence.

#### December-March Itineraries:

Day 6: Drive to Plantation Lodge, overnight. With 16 unique rooms nestled in flowering gardens, Plantation Lodge offers a truly tranquil setting.

Day 7: Cultural visit with the Datoga and Hadza. Drive to

Ngorongoro Serena Safari Lodge for overnight.

Day 8: Ngorongoro Crater. Overnight at Ngorongoro Serena Safari Lodge.

#### June Itinerary:

Day 6: Drive to Lake Eyasi. Cultural visit with the Datoga and Hadza. Overnight at Ngorongoro Serena Safari Lodge.

Day 7: Ngorongoro Crater. Overnight at Ngorongoro Serena Safari Lodge.

Day 8: Drive to central Serengeti. Olduvai visit. Overnight at Mbuli Mawe.

Day 9: In central Serengeti. Overnight at Mbuli Mawe.

#### July-October Itineraries:

Day 6: Drive to Ngorongoro Serena Safari Lodge, overnight.

Day 7: Ngorongoro Crater. Drive to Plantation Lodge, overnight.

Day 8: Cultural visit with the Datoga and Hadza. Overnight at Plantation Lodge.

Note: From Day 9, itineraries will differ between the two seasons depending on where the migration is in the Serengeti. From December through March, following the “short rains” of November and early December, the migrating herds arrive in the short-grass plains of the southern Serengeti to enjoy the





## SOUTHERN SERENGETI: DECEMBER THROUGH MARCH ITINERARY

fresh grasses of the “green season.” This is calving time for the great herds, and our private camp is situated for the best access to the wildlife. See pages 11-12 for details on Days 9-13 of our June–October Northern Serengeti departures.

### DAY 9 OLDUVAI GORGE / SERENGETI NATIONAL PARK / WILDERNESS TRAVEL'S PRIVATE DULANA CAMP

After breakfast at the lodge, we head to the southern Serengeti and Ndutu Plains. Along the way, we visit Olduvai, the small but fascinating archaeological site where Mary Leakey discovered the Zinjanthropus skull. We enjoy a game drive en route to Dulana, our private camp on the edge of “Hidden Valley,” a little-known depression on the southern short grass plains of the Serengeti. Since the camp is set on the edge of the off-road

driving area, we are granted immediate access onto the short grass plains where cheetah are abundant and lion prides have their territory close to camp and the surrounding woodland. Our camp takes advantage of uninterrupted views across

---

“This trip was outstanding and exceeded our expectations. It immersed us in the country, and gave us an unanticipated feel for the bush, its grandeur, its wildlife, its culture. The close association with the Maasai was a special treat, and the ability to explore in open cars and on foot enriched the experience, and left clients of other companies with their mouths agape. When we reflect on the trip, the first word which comes from each of us is ‘wow.’”

*Bob K., Orinda, CA*

---

the shallow valley, where many species of animals can be spotted—and all from the comfort of our tents. Dulana's main lounge and dining tents also enjoy splendid views and are a haven of comfort for the hours of daytime rest. Exclusive and remote, our private camp features roomy walk-in tents with attached bathrooms and hot showers, and comfortable beds made up with linen and a duvet. You can also expect delicious,

freshly cooked meals. Dinner and overnight at private Wilderness Travel camp at Dulana...BLD

## DAYS 10-12 SERENGETI NATIONAL PARK / WILDERNESS TRAVEL'S PRIVATE DULANA CAMP

During these three unforgettable days, we enjoy the privilege of exploring the Serengeti by 4WD vehicle from our own private camp. We have access to a rich mosaic of habitats crisscrossed by the rivers that run through this vast park. Dawn and late-afternoon game drives bring us into varied regions of the park, from the open plains and rock kopjes to river habitats, as game conditions dictate.

The Maasai, who have grazed their cattle on the vast grassy plains of Serengeti for millennia before it became a park, call it Siringitu, "the place where the land moves on forever." Today, Serengeti National Park, along with the Ngorongoro Conservation Area and Masai Mara National Reserve across the border in Kenya, protects the greatest and most varied collection of terrestrial wildlife on earth as well as one of the world's last great migratory systems. The park itself is 5,700 square miles, with open, grassy plains in the south, acacia-dotted savanna in the center, and black clay plains to the west.

We should see vast numbers of migrating wildebeest and zebra, along with Serengeti's resident wildlife, including giraffe, buffalo, topi, hartebeest, waterbuck, impala, reedbuck, bushbuck, dikdik, hippopotamus, crocodile, warthog, and diverse birdlife. Large prides of lion reside here, as well as clans of spotted hyena. The river tracks offer the best chance to see a leopard, usually in the branches of acacia or sausage trees. Cheetah can also be seen here as well as serval and caracal, two smaller African cats. Overnights at private Wilderness Travel camp at Dulana...BLD each day

A note about the spelling of Masai and Maasai: When referring to the Masai Mara, one "a" is used, but "Maasai" is used to refer to the people.

## DAY 13 DEPART ARUSHA

A charter flight brings us to Arusha, where lunch is arranged for us and day rooms are held at the Olerai. Depart Tanzania in the evening, or join one of our many optional trip extensions...BL



## CENTRAL & NORTHERN SERENGETI: JUNE THROUGH OCTOBER ITINERARY

Following the “long rains” of April and May, the migrating herds will have made their way through the Serengeti’s Western Corridor and up to the majestic Lamai Wedge, one of the most beautiful and iconic areas of the northern Serengeti, set between Kenya’s Masai Mara Reserve and the Mara River. They will spend the months of June through October enjoying the cooler weather of the northern Serengeti and crossing back and forth over the Mara River, depending on where the best grazing is. June is a transition month, and on that departure we will spend a few days at a camp in the central Serengeti as the herds make their way north.

---

“Everything we dreamed of and more. Our best trip ever. We’ll definitely use WT in the future.”

---

*Gail P., The Villages, FL*

### DAY 9 OLDUVAI GORGE (JUNE) / SERENGETI NATIONAL PARK / LAMAI WEDGE / WILDERNESS TRAVEL'S AKIBA KIBWE PRIVATE CAMP

On the June departure as we depart Ngorongoro Crater, we visit Olduvai, the small but fascinating archaeological site where Mary Leakey discovered the *Zinjanthropus* skull (see note below). On July through October departures, a charter flight whisks us from the Manyara airstrip to one in the Serengeti. With fantastic game viewing and a picnic lunch en route, we drive into the northern Serengeti and the vast Lamai Wedge, south of the Mara River. Here, the migrating herds and their predators move through open plains dotted with desert date trees, and our camp, Akiba Kibwe, lies directly in their path as they head toward the Mara River. Exclusive and remote, our private camp embodies the true spirit of romance under canvas, and





each tent faces the setting sun. Camp features walk-in tents with attached bathrooms and hot showers, and comfortable beds made up with linen and a duvet. You can also expect delicious, freshly cooked meals. Overnight at private Wilderness Travel camp at Akiba Kibwe...BLD

Note: On the June departure, we visit Olduvai, then continue into Serengeti National Park on a game drive that brings us to Mbugu Mawe Tented Camp, a camp in the central Serengeti with comfortable en suite tented rooms. We spend an additional day here, allowing extra time to view the wildlife while they're still migrating through the central Serengeti before we head north to Akiba Kibwe on Day 11.

#### DAYS 10-12 SERENGETI NATIONAL PARK / LAMAI WEDGE / AKIBA KIBWE PRIVATE CAMP

We explore this remote area of the Serengeti ecosystem, following the movement of game. During this time of year, the Lamai Wedge and Northern Plains Corridor can be a focal

point for huge herds of thirsty wildebeest seeking water in the Mara River (and exciting wildebeest crossings can often be seen here). The diminished grasslands at this time of year force the herds to the very edge of the Serengeti/Mara border, and our camp lies directly in the route of the migrating wildebeest and zebra as they head toward the Mara River. Game viewing

has a completely different feel from the southern areas, with a twist of similarities that complements both locations. The river creates an exciting backdrop and an alternative wildlife haven to the surrounding short grass plains and kopje systems that dot the valleys of this

northern region. Overnight at private Wilderness Travel camp at Akiba Kibwe...BLD each day

#### DAY 13 DEPART ARUSHA

A charter flight brings us to Arusha, where lunch is arranged for us and day rooms are held at the Olerai. Depart Tanzania in the evening, or join one of our many optional trip extensions...BL

---

*"Our second trip with WT and it was absolutely perfect. Still in a dream! It was executed flawlessly. Guides were fantastic and camps and walks were incredible. Loved every moment."*

---

*Nancy R., Palo Alto, CA*

# Trip Details

## TRIP COST

### Prices are per person, valid through 2025

\$10,995 (10-15 members)

\$11,395 (4-9 members)

Single supplement: \$1,095

Charter flight (Dec-Mar, and Jun): \$425

Charter flight (Jul-Sep): \$795

Holiday surcharge (Dec): \$630

Park fees: \$1,965

*Please contact us for future years' pricing*

To offer the lowest possible cost, our trips are priced according to the number of participants on the trip. All costs are per person, based on double occupancy. If you wish to have a single room, you must pay the single supplement fee. Please note that Wilderness Travel staff, or guests of Wilderness Travel such as travel writers, photographers, or leaders-in-training, are not included in the tier pricing count.

## TRIP COST INCLUDES

- Expert leadership of a Wilderness Travel Trip Leader and local guides
- Accommodations, based on double occupancy
- Guaranteed window seating in safari Land Cruisers
- All meals included as indicated in the Detailed Itinerary (B=Breakfast, L=Lunch, D=Dinner)
- Alcohol in our private camps
- Safari camp staff
- Group camping and cooking equipment
- Land transportation and airport transfers as noted, baggage handling
- Membership in Flying Doctor Society for emergency medical assistance

## TRIP COST DOES NOT INCLUDE

International airfare, any meals not specified after each itinerary day, park entrance fees, transfers for independent arrival or departure, airport departure taxes, optional tipping or gratuities to leaders or staff, additional hotel nights made necessary by airline schedule changes or other factors, pre-trip expenses such as medical immunizations (if any), travel insurance, or passports and visas; and other expenses of a personal nature (alcoholic beverages at Plantation and Serena lodges, laundry, etc.).

## PAYMENT SCHEDULE

At time of reservation: \$600

90 days prior to departure: Balance

## CANCELLATION AND TRANSFER FEE SCHEDULE

Up to 91 days prior to departure: No charge!

61-90 days prior to departure: 25% of trip cost

46-60 days prior to departure: 50% of trip cost

45 days or less: 100% of trip cost

## CURRENCY EXCHANGE RATE

Because the prices published for our program are set so far in advance of the trip dates, we are occasionally faced with exceptional cost increases and/or currency fluctuations that affect the actual cost of running the trip. In most years, no price changes are necessary. However, we do reserve the right to raise or lower the trip price if there is a significant change in costs or exchange rates. If this is the case, your final invoice will reflect the difference in trip cost.

## TRAVEL INSURANCE

We highly recommend you purchase travel insurance. You can take advantage of a comprehensive Travel Protection Plan designed for Wilderness Travel by Travelex, or purchase other insurance on your own. See our website for details:

[www.wildernesstravel.com/insurance](http://www.wildernesstravel.com/insurance)



## Exclusive Tented Camps—WT Style

Wilderness Travel’s seasonal tented camps are strategically positioned well away from the lodge circuit in locations that put you in the heart of the wildlife action. In addition to offering delightful privacy and a sense of wilderness serenity, the camps pamper you with superb service and delightful amenities. And with a staff to guest ratio of 1:1, you will find them a relaxing oasis after a day on safari. Because the camps are exclusive to our group, you are guaranteed an intimate safari experience where each day’s itinerary can adapt as each wildlife viewing experience presents itself.

### ELEGANT DINING

Mealtime at our private camps is an unexpected highlight for many guests, with a mouth-watering array of fresh foods and baked goods prepared on site by our great cooks who are easily able to accommodate most diets. Menus

feature expertly prepared dishes like lamb curry, lentil salad with tomatoes and mint, grilled vegetables, and chicken



saltimbocca. Enjoy gourmet picnics beneath the shade of an acacia tree near grazing giraffe, and multi-course meals by candlelight served in our camp’s deluxe dining tent. Wherever the meal, you’ll feel as if you are in a fine restaurant, while the sights and sounds of the bush remind you that you are on safari!

### LIVING UNDER CANVAS

The delightful location of each camp will put you in a romantic world apart. We’ll return each day from safari to enjoy stories and laughter around the campfire with a complimentary open bar, before gathering for dinner served in a big, airy open-sided dining tent. Each night you drift to sleep to the enchanting sounds of the African night, enjoying the comforts of your own spacious tent featuring oriental carpets and a real bed (no cots!), along with an en suite bathroom and shower. We achieve all of this with a light environmental footprint—we use rechargeable resources and propane refrigeration instead of noisy generators, and offset all of our fuel usage through a carbon offsetting program.

## SPACIOUS TENTS

Your walk-in canvas tent (approximately 30 x 16 feet) is furnished with a king-sized bed (or two singles) cotton duvets, sheets, pillows, and battery-powered lighting. A small veranda at the front has camp chairs, a great place to relax and read.

## PRIVATE BATHROOMS

At the rear of the tent is your attached bathroom, with a dressing room, warm-water shower, sink, and toilet.

## PERSONAL SERVICE

You'll have your own tent steward, along with complimentary daily laundry service.

## WELCOMING CAMP STAFF

Our top-notch camp service is personable and professional, and most of our staff have worked with us for many years. By the end of your stay, they will feel like family and it can feel bittersweet to bid farewell to them as you head back home! Several of our camp watchmen and hiking guides come from local Maasai tribes, so you'll also have the opportunity for fascinating cultural exchanges.

"The wilderness camps, and the staff that ran them, were just spectacular. Everything from fresh coffee brought to the tent every morning to drinks around the fire before dinner to hot showers every evening was just perfect, not to mention the views of the African landscape out the front door, with the only sounds the songs of birds . "

*Janet S., Boise, ID*

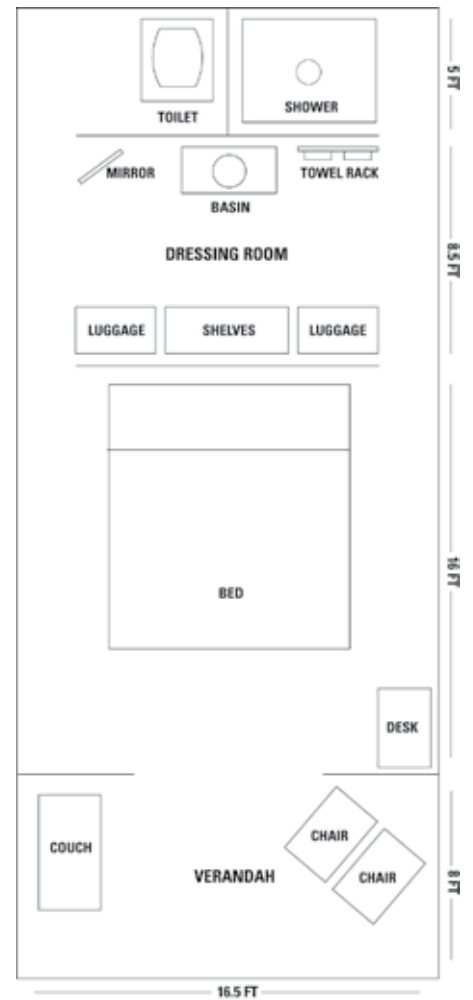

TENT LAYOUT ABOVE IS FOR TARANGIRE; SERENGETI TENTS MEASURE 30' X 14.5'



# Other Lodging

## THE PERFECT COMPLIMENT TO YOUR CAMPING SAFARI



### OLERAI

*Arusha, Tanzania*

*Day 1 (1 night), Day 13 (Day Room)*

Once a private home, the Olerai is set on eight acres on the outskirts of Arusha. It welcomes guests with nine en suite rooms spread over the garden grounds. The family-style dining veranda overlooks the manicured lawns, and in the evenings, the fire is lit for socializing over a gin and tonic or regional wine. Mercy, the chef, and her crew prepare delightful cuisine for a farm-to-plate experience with home-grown vegetables and herbs. Olerai provides free Wi-Fi, concierge service, and massage services on request.

### NGORONGORO SERENA SAFARI LODGE

*Ngorongoro Crater, Tanzania*

*Day 6 (1 night) July through October*

*Days 7 to 8 (2 nights), December through March, June*

This 75-room international-style hotel enjoys a spectacular setting on the rim of the Ngorongoro Crater. Built from local river stone, the lodge complex offers spacious rooms, handsomely decorated with stylized cave painting, and each with its own balcony granting uninterrupted views of the amphitheater below. Though you're in the heart of Africa, there are direct-dial telephones and even Wi-Fi! Dinner is buffet style, with something for everyone.



### PLANTATION LODGE

*Ngorongoro Conservation Area, Tanzania*

*Day 6 (1 night) December through March*

*Days 7 to 8 (2 nights) July through October*

With 16 lovely cottages spread out across flowering gardens and located near the Ngorongoro Crater, this elegant lodge has a peaceful setting and is in fact a working coffee plantation. The lodge offers very comfortable and nicely decorated rooms with en suite bathroom, a small sitting area, and a spacious veranda overlooking the gardens, which provide many of the vegetables and fruits served in the restaurant. There is a welcoming bar with a good wine list and the staff offers complimentary appetizers on the terrace before dinner. Or, enjoy a sundowner by the pool!







## Our Safari Vehicles

Wilderness Travel's primary vehicles for this safari are Toyota Land Cruisers, renowned for being the most rugged and reliable 4X4 safari vehicles in the world. They excel in off-track terrain and each has been custom-modified with Volvo seats that offer adjustable lumbar support. With a maximum of just five guests per vehicle, each passenger is guaranteed his or her own window seat and ample room to stretch out—both for your legs and your camera gear! And best of all, the drivers are under no mileage restrictions—they will go where the wildlife viewing is best, and are under no pressure to limit their route to save gas, as is common in both lodge-based safaris and cheaper safaris, which use the cramped “pop-top” mini-vans that can't go off-road.

### OUR VEHICLES HAVE BEEN EQUIPPED WITH:

- Roofs that pop up, providing you with unobstructed views and an ideal vantage for getting great photos, as well as welcome shade.
- Air conditioning as needed during warmer seasons when the hatches are closed (usually when traveling at higher speeds or when dusty or raining).
- Bean bags to help steady your longer lenses and get perfect wildlife shots.
- Multiple US-style outlets for recharging your batteries and other devices.
- An Engle Fridge with cold drinks and snacks.
- Refillable water bottles and thermos bottles of tea/coffee
- VHF Radio for communication between vehicles and HF Radio for long distance communication back to the Arusha office.
- On-board library, including field guides and maps of Tanzania and the national parks.
- First-aid kit.
- Fire extinguisher and comprehensive spares and tools.

### “OPEN” SAFARI VEHICLES

At our Osunyai Lamarkau Camp in Tarangire, we will enjoy our daily game drives in “open” safari vehicles. These are rugged Land Cruisers, but we've stripped the walls and roof off the chassis to allow you to feel that there is nothing between you and the sights, sounds, and smells of Tanzania. It's a delightful experience and it offers excellent game viewing as the seating is gradually tiered, with the back rows higher than the front—similar to theater seating. There is an awning overhead to offer sun protection. Obviously, an open vehicle like this is only appropriate when the weather is good and there is no need to travel at fast speeds.



# Our Guides

## MAKE ALL THE DIFFERENCE

The skilled guides at Wilderness Travel transform your safari from amazing to absolutely life-changing. As you look for game alongside these delightful masters of safari, you will be astounded by their vast knowledge, keen eyes (how do they see so incredibly far?), boundless energy, and warm personalities. Our extraordinary guides are a vital component of this adventure. They focus on all the details, from keeping you safe in the bush to finding wildlife in places our untrained eyes would miss, answering your every question, and even helping you set up your camera for the best shot. All native Tanzanians who have been with WT for years, they have an immense love for their country and a belief in the positive impact safaris can bring to supporting conservation. They are the true treasures of our safari, and you will certainly leave the trip calling them not just “friends,” but “family.”



### NAIMAN MUNGURE

Naiman Mungure, a graduate of the National Outdoor Leadership School (NOLS), has been leading wildlife safaris for nearly two decades. Whether strolling among riverine forests in search of rare birds or navigating his way across the short grass plains of the Serengeti, Naiman has a sense of what makes a great safari experience and ensures that all his guests leave Tanzania with a new insight into the wonders of his native country. His quiet personality and depth of knowledge make him one of our most likeable guides. Naiman is married and has three daughters and one son. When not on safari, he enjoys looking after his farm in Babati, northeast of Arusha.



### MZEE JUSTICE MWANGANGI

Mzee Justice, whose name means “revered elder” in Swahili, has been a professional safari guide since 1994. His guiding prowess incorporates a hunter’s eye and he can spot game in circumstances beyond the normal realm of most people’s visual abilities. Active in every aspect of his home country’s conservation efforts, he encourages awareness among his fellow Tanzanians of the huge value that wilderness and natural history can play in Tanzania’s progress. Mzee possesses a wonderful combination of charm, humor, and a wealth of knowledge.



### GOODLUCK URASSA

Goodluck Kilesi Urassa, known as Urassa, is a member of the Meru tribe from the southern slopes of Mount Meru, near Arusha. He knew from an early age that he wanted to become a safari guide, and after attending Mount Meru Tour Guiding College, he entered the profession, rising through the positions of camp crew, support vehicle driver, assistant guide, and now safari guide. His interests include mammal behavior, a particular favorite, and ornithology, a close second. Urassa gives back to his community by doing environmental work in his home area, for example, planting indigenous trees with school children on the slopes of Mount Meru, and educating them about environmental issues. Urassa has a keen spotter's eye, a love of the bush, and a wit and gentle manner that make him a great safari companion. He lives near his home village with his wife Stella and his three children.

# Extend Your Adventure

To help you make the most of your adventure, we've created several exciting trip extensions. For detailed information, including full itineraries and complete pricing, please visit our webpage and click on "Extend Your Trip": [www.wildernesstravel.com/trip/tanzania-serengeti-great-migration-safari/](http://www.wildernesstravel.com/trip/tanzania-serengeti-great-migration-safari/)

## MASAI MARA NATIONAL RESERVE EXTENSION

Set at an altitude of about 5,000 feet, the Masai Mara National Reserve is breathtakingly beautiful with the wide Mara River, one of Kenya's largest rivers, snaking through its green, tree-studded grasslands. The river is home to many hippos and enormous groups of elephant that wander through the lush marshes along the river's edge. Among the plains game found in the Mara are eland, topi, zebra, giraffe, and Thompson's and Grant's gazelle, and buffalo graze here in abundance. There are also some of the rare and endangered black rhino, not always easy to find but a wonderful sight when encountered. The Mara is one of the best places in Kenya to see lion, as there are numerous roaming prides. Early booking is recommended due to limited availability.

*4 days. From \$5,695.*



## GORILLA TRACKING IN RWANDA'S PARC NATIONAL DES VOLCANS EXTENSION

Join your ranger-guide for the exhilarating experience of tracking and observing the mountain gorilla clans that reside in the spectacular montane forests of Parc National des Volcans, where researcher Dian Fossey was based for 13 years. The hiking terrain ranges in altitude from 3,800 to 8,500 feet and preserves one of the largest natural forests in East Africa.

*5 days. From \$3395.*



# What to Expect

## WHAT THE TRIP IS LIKE

This trip is rated Level 2+, Easy to Moderate, according to our trip grading system. This is a camping and lodge safari with game viewing by 4WD vehicle and nature walks that can be enjoyed by anyone in reasonably good health. There are a few long driving days over rough roads and rugged dirt tracks. At our private camps, we have opportunities for optional bush walks with a professional tracker as well as the flexibility to go out on game drives. The game-tracking walks are not difficult and are conducted at a pace that allows an intimate exploration of the African bush. Although this is not a particularly rigorous trip, we recommend that each participant undertake a preparatory program of physical conditioning. Daily walking or regular hiking, jogging, and stair-climbing are excellent ways to prepare for the trip. Any African safari is an adventure, and the traveler to Africa should bring along flexibility, a sense of humor, curiosity about new peoples and places, and an openness to the unexpected.

## GAME DRIVES & WILD ANIMALS

Game drives are in 4WD Land Cruisers with guaranteed window seating (maximum of 5 passengers per vehicle)—there's no taking turns for the window seats. At Akiba Kibwe and Osunyai, we also enjoy the freedom of exploration in open 4WD vehicles. A cooler of drinks and refreshments is carried aboard, along with a library of field guides and maps. We also do extensive gameviewing while traveling between game parks. Often, our Land Cruisers will split up in the parks to track game separately (each vehicle has a sophisticated radio system). Our 4WD vehicles can go virtually anywhere, an important feature when we're tracking game, and they add a sense of adventure to your African safari.

During drives, we can at times get quite close to wild animals. Being very quiet improves everybody's chances of observation. In the interest of safety, your Trip Leader explains limitations on movement while on game drives, in the safari vehicles, and around camp. Incidents with wild animals are extremely rare on safaris, but no camping safari can guarantee immunity from such incidents. Wilderness Travel is not to be held responsible for incidents involving the behavior of wildlife.

## WEATHER

December to March is East Africa's "summer" with daytime temperatures from 80°-90° and evenings from 50° to 60°. June, July, and August are the coolest months, with lows around 40° and highs of 70°-80°. September, October, and November are warmer, with lows around 65° and highs of 75°-85°. Scattered rains occur in November and early December, which help to lay the dust.

## CHOOSING THE RIGHT TRIP

Adventure travel often involves exotic destinations, unusual levels of physical exertion, or activities you may not have participated in previously. We work hard to help you choose the right trip for you, paying attention to your individual interests, abilities, and needs. If you have questions about the level of comfort or any of the activities described in this itinerary, please call Wilderness Travel at 1-800-368-2794 and ask for the Africa Manager or email us at [africa@wildernesstravel.com](mailto:africa@wildernesstravel.com).

Average Daily Max/Min °F												
	Jan	Feb	Mar	Apr	May	Jun	Jul	Aug	Sep	Oct	Nov	Dec
Arusha	84/59	86/59	84/61	79/63	75/61	73/57	73/55	75/55	79/57	82/59	82/61	82/61
Ngorongoro	73/50	73/50	72/50	70/52	68/50	66/46	66/46	68/46	70/46	72/48	72/50	72/50
Serengeti	82/59	82/59	82/59	79/61	79/59	77/57	77/55	79/57	79/57	82/59	81/59	81/59
Tarangire	84/61	86/61	84/63	81/64	77/63	75/57	75/57	77/57	81/59	84/61	84/63	84/63
Rainfall - Inches												
Arusha	2.5	2.5	5.7	13.3	6.7	1.5	0.8	0.6	0.6	1.5	5.0	3.6
Ngorongoro	4.3	3.5	5.4	8.4	3.9	0.9	0.5	0.6	0.4	2.2	4.5	5.4
Serengeti	3.2	3.9	4.8	5.4	2.7	0.9	0.4	0.7	1.3	2.0	3.9	3.8
Tarangire	3.1	3.6	5.2	7.0	1.9	0.2	0.0	0.0	0.1	0.6	3.0	3.7

## REFERENCES

We'd be happy to put you in touch with a past client that has traveled with us on this or a similar trip.

## VISIT OUR WEBSITE

At [www.wildernesstravel.com](http://www.wildernesstravel.com), you can book your trip online or find out about added departures, last-minute deals, and one-time Limited Edition adventures that aren't listed in our catalog. You can also access our complete library of detailed itineraries filled with enticing photos and videos, read bios of our Trip Leaders, find descriptions of trip accommodations, and check real-time availability of any trips that interest you.

## PROTECTING THE SERENGETI ECOSYSTEM

Wilderness Travel is proud to be a founding member of the Friends of Serengeti, which brings together travel companies and travelers to build support, advocacy, and funding for the Serengeti ecosystem in both Tanzania and Kenya. Without our support, the Serengeti, Masai Mara, and surrounding protected areas are in danger of being lost forever. We believe that the success of sustainable tourism will be the deciding factor in whether the Serengeti ecosystem will survive, and a key element is bringing tangible social and economic benefits from tourism to local people. You will be provided with an opportunity to make an optional donation to Friends of Serengeti at the time of your final payment. We also support other organizations working in Africa, including the Jane Goodall Institute, the Cheetah Conservation Fund, and Save the Elephants. [Download more information here.](#)

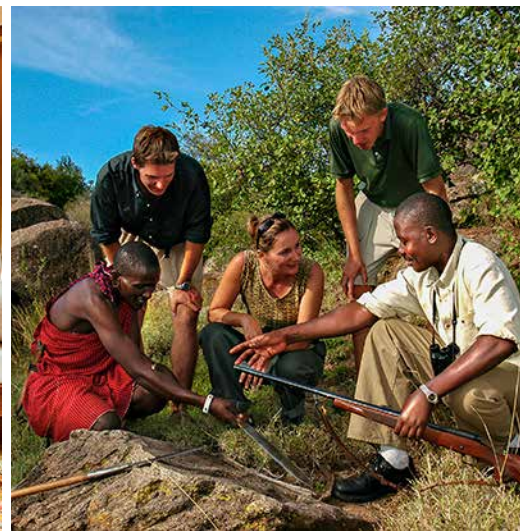

# Arrival & Departure

Upon confirming your trip reservation, we will send you a Welcome Packet that includes a list of documents (passport, visas, etc.) required for your trip. Please feel free to call if you would like this information before making your air arrangements.

## ARRIVAL & MEETING PLACE

Arusha, Tanzania

**Suggested Airport:** Kilimanjaro International Airport (JRO)

**Suggested Date & Time:** Day 1, anytime

**Meeting Place:** A complimentary transfer is provided from Kilimanjaro International Airport to the Olerai for all trip members. Your Trip Leader or a WT representative will meet you outside the customs area and will be holding a Wilderness Travel sign.

If you have booked extra services for early arrival, an Extra Services Confirmation will be sent with your Final Documents.

## DEPARTURE

Arusha, Tanzania

**Suggested Airport:** Kilimanjaro International Airport (JRO)

**Suggested Date & Time:** Day 13, anytime after 5:00 pm

On Day 13, we fly to the town of Arusha. After lunch, we transfer to Olerai, where day rooms are held for the group. A complimentary transfer will be provided from the hotel to Kilimanjaro International Airport for evening flights.

## INTERNATIONAL AIR TRAVEL

You are responsible for making your own arrangements for flights to and from Tanzania. Airlines with the most convenient schedules for this trip include:

**Qatar Airways**

[www.qatarairways.com](http://www.qatarairways.com)

**Delta/KLM Airlines**

[www.delta.com](http://www.delta.com)

[www.klm.com](http://www.klm.com)

There are many online consolidators for booking travel, but for more personal help arranging air transport, you can contact Exito Travel at 1-800-655-4053 in the US or 1-800-670-2605 in Canada. They are very adept at putting flight itineraries together, to even the most far-flung places. More information can be found on Exito's website at [www.exitotravel.com](http://www.exitotravel.com).

The name on your airline ticket must match the name on your passport exactly, and your passport must be valid for at least six months after your date of return to the US.

**Please do not purchase your tickets until you are confirmed on the trip.** Once your tickets have been purchased, please send us a copy of your airline schedule so we can reserve your airport transfers.

## SUGGESTED INTERNATIONAL AIR SCHEDULE

Delta/KLM Airlines has the most convenient schedule to Arusha, Tanzania, with a stop in Amsterdam. Due to flight schedules, departure from the US is one or two days prior to Day 1.

**Pre-Trip Day:** Depart US from your hometown.

**Day 1:** Arrive in Amsterdam early in the morning, and depart on KLM at approximately 11:00 am. Arrive in Arusha at 8:00 pm.

**Day 13:** Depart Arusha on KLM at approximately 9:05 pm.

**Day 14:** Arrive Amsterdam at approximately 7:35 am and connect to onward flights.

**Flights times are subject to change without notice.**

**Note:** If you are traveling between December-March, consider leaving a day earlier if your hometown city airport (or connecting city airport) may be subject to airport closures or flight delays due to inclement weather.

## AMSTERDAM STOPOVER

If you have an Amsterdam stopover, we recommend the Canal House ([www.canalhouse.nl](http://www.canalhouse.nl)). Situated on one of the major canals, the Keizersgracht, it has 26 rooms furnished with period antiques, and a bed and breakfast atmosphere. Contact them at [info@canalhouse.nl](mailto:info@canalhouse.nl) for reservations.

# Travel Notes



## WILDERNESS TRAVEL HAS BEEN AWARDED:

**Best Travel Specialists in the World:** *Conde Nast Traveler*, 2024, 4-time winner

**World's Best Tour Operators:** *Travel + Leisure*, 11-time winner

**Best Wildlife, Hiking & Walking Trips:** *AFAR Magazine*, 3 years in a row

**Best Adventure Travel Companies:** *USA Today*

**Trip of the Year:** *Outside Magazine*, 9-time winner

**50 Tours of a Lifetime:** *National Geographic Traveler*, 9 years in a row

**Best Adventure Travel Companies:** *National Geographic Adventure*, 3-time winner

Please be advised that California has established a Travel Consumer Restitution Fund under the California Seller of Travel Law that took effect January 1, 1996. This fund is designed to protect consumers from unscrupulous practices by discount airfare ticket sellers or air charter operators. Unfortunately, this law does not cover non-California residents and, even in the case of California residents, it does not cover any foreign travel where the foreign "providers of transportation or travel services" are not in compliance with the Sellers of Travel Law (compliance being defined as registered as a Seller of Travel in California and a participant in the Travel Consumer Restitution Fund). Thus none of Wilderness Travel's tours qualify and we are required by law to advise each client that they are not covered by the California Travel Consumer Restitution Fund. California law requires sellers of travel to maintain a trust account or bond. This business has a trust account. California Seller of Travel #100769640

While as accurate as possible at the time of printing, this itinerary should be considered an approximate indication of the schedule and scope of activities and trip routing, rather than an inflexible schedule of events; it is subject to change due to circumstances beyond our control. This trip is subject to the Limitation of Liability and all the terms and conditions as detailed in the General Information section of the Wilderness Travel Catalog.

Revised: September 23, 2024 2:28 PM



1102 Ninth Street, Berkeley, CA 94710

800-368-2794 • 510-558-2488

[www.wildernesstravel.com](http://www.wildernesstravel.com) • [info@wildernesstravel.com](mailto:info@wildernesstravel.com)