

Tanzania Private Safari

TARANGIRE NATIONAL PARK, NGORONGORO, AND THE SERENGETI



Wilderness Travel



Tanzania Private Safari

WHEN TO GO

December to March
June to October

For our Private Journey trips, you choose your own group and your preferred dates—there are no set departure dates. Private Journeys are available to groups as few as two people or as large as you like. While many guests choose to book this tour exactly as is, our Area Specialists can work with you to customize it to your wishes. Contact us for availability, questions, or to book your adventure! Due to limited availability, booking early is recommended.

Prowling lions, hyenas calling in the night, massive herds of elephants, shimmering stars overhead—all the mystique and wonder of Tanzania await you on this Private Journey. To bring you wildlife encounters in its most legendary settings, we've combined three world-renowned sanctuaries—the migrating wildlife of Tarangire National Park, drawn by the permanent waters of the Tarangire River, spectacular Ngorongoro Crater, and the mythical Serengeti, where the earth's greatest gathering of terrestrial wildlife roams freely on golden savannas. Expert private naturalist guides, fascinating bush walks, exciting game drives, Maasai culture, and fantastic private camps in prime locations make this the quintessential safari. Post-trip, enjoy a visit to the paradisaical island of Zanzibar or gorilla tracking in Rwanda.

What Makes WT's Tanzania Private Safari Special?



EXCLUSIVE PRIVATE LUXURY CAMPS

Our seasonally adjusted itineraries, perfected over nearly four decades, are designed to get you right into the heart of the Great Migration in the Serengeti no matter what time of year you go. We get you away from the lodge circuit and its crowds—and what a difference that makes! You'll also enjoy luxurious private camps in Tarangire. And though it may be called camping, the experience is more like a dream hotel.



PRIVATE VEHICLES, SPECIALLY DESIGNED FOR SAFARI

We'll travel in private Land Cruisers which guarantee each passenger has their own window seat and ample room to stretch out—both your legs and your camera gear! Rather than use crowded minibuses that can't go off-road, we use rugged extended cab 4x4s with three rows of seats for only 5 passengers and a separate roof hatch for each row of seats. This allows you delightful personal space with unobstructed views and an ideal vantage for getting great photos.



A VARIETY OF ACTIVITIES

In addition to our phenomenal daily game drives, we've woven a variety of other activities into the experience, from off-road travel in our sturdy 4x4s to exciting game walks, night drives, fascinating cultural encounters with the Masai, and a charter flights that minimizes long drives and offers the likely chance of spectacular aerial views of the Serengeti.

PRIVATE EXPERT LEADERS

You will have a private guide, exclusive to your group. Our expert Trip Leader and assistant naturalist guides accompany you throughout the entire safari—you aren't handed off to different guides as you often are on a lodge-based safari.



TARANGIRE! THIS HIDDEN GEM OFFERS THE LAST TRUE LUXURY IN TRAVEL: EXCLUSIVITY

While the Serengeti and Ngorongoro Crater are Tanzania's big draws, one of its most fantastic hidden gems is Tarangire National Park, especially its remote southern end, where our delightful private camp is located. Enormous herds of elephants and buffalo await, along with excellent leopard sightings, the chance to do night drives, bush walks—all of which are not possible in the Serengeti or Ngorongoro—as well as fascinating visits to still very traditional Maasai villages, and best of all you'll feel as if you have all of Africa to yourself!



The Serengeti Migration

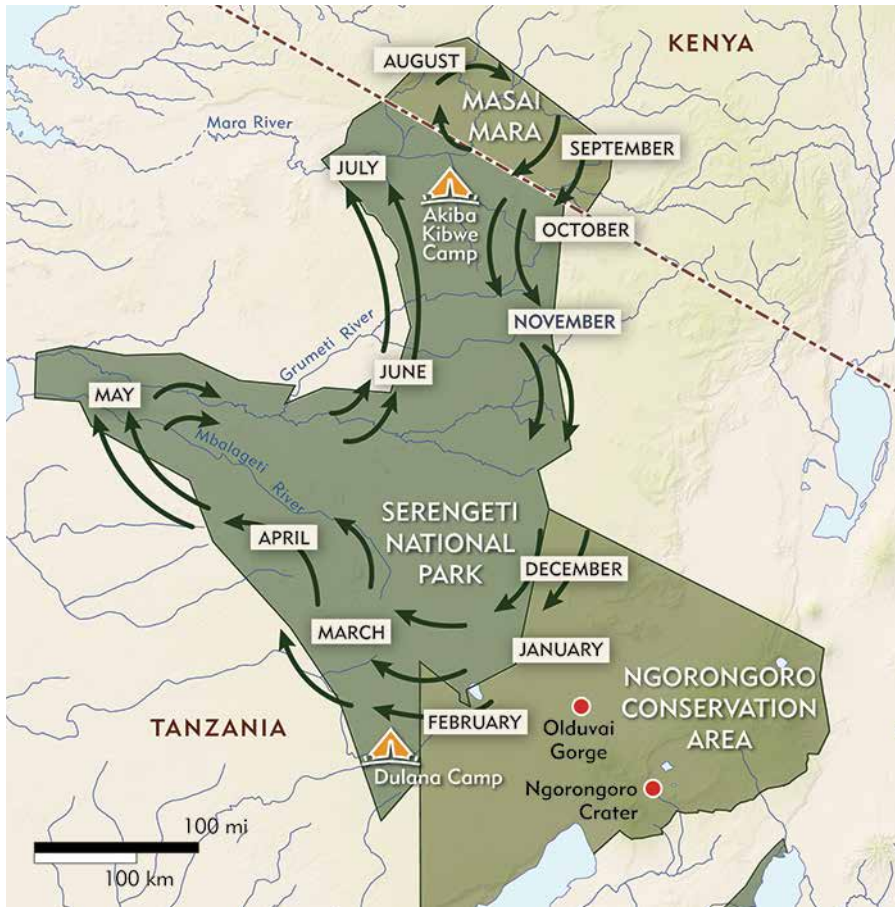

WHAT IS THE GREAT MIGRATION?

The Great Migration is the largest mass movement of land mammals on Earth, when more than a million wildebeest—along with hundreds of thousands of zebra and gazelle, stalked by predators like big cats and hyenas—circle through the Serengeti plains in Tanzania and Masai Mara Reserve in Kenya. Following instinct and the scent of moisture, the herds move clockwise from their calving grounds in the lush plains of the southern Serengeti, moving to the northern Serengeti as the plains dry out, and spending the summer and early fall here before heading south again in the fall to repeat the cycle. The scale of this event, and the encounters between predator and prey, offer an extraordinary and unequalled wildlife spectacle. Witnessing it firsthand is an awe-inspiring privilege.



When is the Best Time to See it?

The short answer is that you can't go wrong, because the migration never truly stops. Whenever you choose to go, the wildlife experiences are always extraordinary. We move our Serengeti camps seasonally to follow the herds, giving you access to world-class game viewing on every departure. Wilderness Travel offers Serengeti safaris in two seasons: from December through March, when the migration is in the south and the wildebeest give birth and nurture their calves, and from June through October, when the herds mass at the northern end of the park, preparing to cross the Mara River into Kenya.

SOUTHERN SERENGETI: DECEMBER THROUGH MARCH



DAY	ITINERARY IN BRIEF
Day 1	Arusha
Day 2-4	Tarangire, Osunyai Lamarkau Camp
Day 5-6	Ngorongoro, Plantation Lodge
Day 7-9	Serengeti, Dulana Camp
Day 10	Arusha

More than two million years ago, volcanic eruptions spewed ash and debris onto the southern Serengeti plains, enriching the surrounding soil. As a result, lush grasses grow here in the green season—making it the perfect feeding ground for pregnant wildebeest to graze and produce nutrient-dense milk. Over a period of just a few weeks, females give birth to more than 300,000 calves; the presence of these wobbly-kneed newborns draws predators like big cats and hyena.

Our Dulana Camp sits near their migratory route, where columns of wildebeest can be seen stretching for miles, sometimes passing right by the camp itself! This is also an excellent time of year for bird-watching, as there is an abundance of migratory flocks passing over the plains.

NORTHERN SERENGETI: JUNE THROUGH OCTOBER



DAY	ITINERARY IN BRIEF
Day 1	Arusha
Day 2-4	Tarangire, Osunyai Lamarkau Camp
Day 5-6	Ngorongoro, Plantation Lodge
Day 7-9	Serengeti, Akiba Kibwe Camp
Day 10	Arusha

By this season, the herds will be in the northwest, having made their way from the western corridor of the park, and by June arriving at the Grumeti River, which now runs low and teems with opportunistic Nile crocodile. As the main body of the herd continues north over the summer months, wildebeest mass on the banks of the Mara River in incredible numbers before the hardest single part of their long journey: a dramatic, life-or-death river crossing into Kenya.

This is one of the greatest wildlife shows on Earth. In the northern Serengeti, we stay at our Akiba Kibwe Camp, ideally positioned by the Mara River. We spend several days here, giving us a great chance of witnessing the dramatic river crossings made so famous in many wildlife documentaries.



Tanzania Private Safari Itinerary



This Private Journey uses a combination of hotels, exclusive lodges, and private camps. These properties are often reserved well in advance. We urge you to make your reservation as early as possible to ensure availability on your preferred dates.

DAY 1 ARRIVE IN ARUSHA, TANZANIA

Late evening arrival at Kilimanjaro Airport near Arusha. You will be met and transferred to the Olerai or Arusha Serena Hotel, both set in tranquil flowered gardens. (Note: groups of five or more stay at Olerai, groups of four or less stay at Arusha Serena Hotel). You can also upgrade to Legendary Lodge. Dinner and overnight at the lodge...D

TRIP DETAILS AT-A-GLANCE

- Length:** 10 days
- Arrive:** Arusha, Tanzania
- Depart:** Arusha, Tanzania
- Lodging:** 6 nights private tented camps, 3 nights lodge or hotel
- Meals:** All meals included as noted in Detailed Itinerary (B=Breakfast, L=Lunch, D=Dinner)
- Activity:** Safaris, Wildlife and Natural History
- Trip Level:** 1 2 3 4 5 6
Game viewing by open 4WD vehicle, optional game walks

DAYS 2-4 TARANGIRE NATIONAL PARK

The morning is at leisure, with lunch at the lodge. In the afternoon, take a scheduled charter flight to Tarangire National Park, where you meet your private safari guide and vehicle for a transfer to camp, enjoying a game drive en route. The thousand-square-mile Tarangire region is a haven for wildlife with an extremely rich game viewing potential: herds up to 300 elephants scratch the dry river bed for underground streams, while migratory wildebeest, zebra, buffalo, impala, gazelle, hartebeest, and eland crowd the shrinking lagoons. It has the greatest concentration of wildlife outside the Serengeti ecosystem, and the one place in Tanzania where dry-country antelope such as the oryx and the renyek are regularly observed. In addition to daytime game drives in this slice of untamed Tanzania, the camp offers night drives and bush walks. You will also have a special Maasai Olpul ceremony at the camp, with opportunities to learn more about the Maasai way of life. Also included is a guided nature walk near camp to learn how the Maasai use the local plants. Overnight at your private camp at Osunyai Lamarkau (note that with groups of 4 or less we do not guarantee exclusive use of the camp, but you will have a private guide and vehicle)...BLD each day



DAYS 5-6 NGORONGORO CRATER

After breakfast, head out for a game drive to the Ngorongoro Highlands and on to Ngorongoro Crater. Ngorongoro's beauty and vastness must be seen to be believed: on the crater's 105-square-mile grassy floor lives Africa's largest permanent concentration of wildlife, a sort of mini-Serengeti in a phenomenally scenic setting. During your two days here,

you're likely to see elephant, zebra, wildebeest, and buffalo, and there's hardly a better place on earth for observing lions than on the crater floor, where the lion prides are large. This is also one of the best places to see the endangered black rhino—about a dozen have been introduced into the crater environment. Overnight at the Plantation Lodge...BLD each day
Classic Accommodation: Plantation Lodge

A note about the spelling of Masai and Maasai: When referring to the Masai Mara, one "a" is used, but "Maasai" is used to refer to the people.

DAYS 7-9 SERENGETI MIGRATION CAMP

During these three unforgettable days, explore the Serengeti by 4WD vehicle with your private guide. Dawn and late-afternoon game drives bring you from the open plains and rock kopjes to river habitats, as game conditions dictate. The Maasai, who have grazed their cattle on the vast grassy plains of Serengeti for millennia before it became a park, call it

Siringitu, "the place where the land moves on forever." Today, Serengeti National Park, along with the Ngorongoro Conservation Area and Masai Mara National Reserve across the border in Kenya, protects the greatest and most varied collection of terrestrial wildlife on earth as well as one of the world's last great migratory systems. The park itself is 5,700 square miles, with open, grassy plains in the south, acacia-dotted savanna in the center, and black clay plains to the west.

"What an exceptional itinerary, safari, and camping experience! The volume of animals is extraordinary and our guides did a great job of finding things that few others would find. I'll never forget how moving seeing these animals in their natural habitat was. The bush camps were exceptional—brings new meaning to 'glamping!' Being able to stay in the bush in comfort really magnified the overall excellence of the safari."

Steve S., San Francisco, CA

You should see vast numbers of migrating wildebeest and zebra, along with Serengeti's resident wildlife, including giraffe, buffalo, waterbuck, hippopotamus, crocodile, warthog, and diverse birdlife. Large prides of lion reside here, as well as

clans of spotted hyena. The river tracks offer the best chance to see a leopard, usually in the branches of acacia or sausage trees. Cheetah can also be seen here as well as serval and caracal, two smaller African cats. Overnights at Dulana Camp or Akiba Kibwe Camp, depending on the season (note that with groups of 4 or less we do not guarantee exclusive use of the camp, but you will have a private guide and vehicle)... BLD each day

DAY 10 DEPART ARUSHA

A scheduled charter flight brings you from the Serengeti to Arusha, where lunch is arranged for you and day rooms are held at an Arusha hotel. You'll have some free time to shop and enjoy the city of Arusha. Depart Tanzania in the evening, or join one of our many optional trip extensions...B

"Words can't express what a trip this was. Our Tanzanian guide Naiman was simply amazing—he was like family by the time we left. Every day was an adventure and delivered a new, unexpected thrill."

Will C., Seattle, WA

Note: On June-October departures, we explore the northern section of the Serengeti (additional flight from Lake Manyara to the Serengeti required). The diminished grasslands at this time of year force the herds to the very edge of the Serengeti/Mara border, and our camp lies directly in the route of the migrating wildebeest and zebra as they head toward the Mara River.



Trip Details

TRIP COST

Prices are per person, valid through 2025

\$9,295 (8-14 members)

\$9,795 (4-7 members)

Single supplement: \$775

Internal airfare: \$890 (subject to change)

Child Discount (under 16): \$1,000

Park Fees: \$1,890

Note: We need a minimum of 4 trip members to run the trip.

Prices are based on double occupancy and not guaranteed until services are confirmed.

Make it Your Trip!

The prices above are for the ready-to-book adventure outlined in this Detailed Itinerary, a popular option that has been handcrafted by our Area Specialists to include the best of every destination. While many travelers choose to book this tour as is, our Area Specialists are also happy to work with you to customize this Private Journey to suit your specific interests and style of travel. We can arrange for longer or shorter stays, offer hotel upgrades (see below for sample costs), or add an extension to additional places of interest. We can even add special activities or customize excursions depending on your interests. We invite you to contact us to discuss your options!

Optional Hotel Upgrades

All upgrade pricing is per person, per night, based on double occupancy. Please call for single occupancy pricing.

Arusha: Legendary Lodge, from \$165

TRIP COST INCLUDES

- Accommodations as noted in the Detailed Itinerary, based on double occupancy
- All meals as noted in Detailed Itinerary
- Services of safari guides and camp staff
- 4WD safari vehicles
- Land and internal air transportation as noted
- All airport transfers and airport assistance at Kilimanjaro Airport
- Night game drives, bush/nature walks and Masai cultural activities are included at Osunyai Lamarkau

TRIP COST DOES NOT INCLUDE

International airfare, any meals not specified after each itinerary day, any activities described as optional, airport departure taxes, optional tipping or gratuities to staff, additional hotel nights made necessary by airline schedule changes or other factors, pre-trip expenses such as medical immunizations (if any), travel insurance, or passports and visas; and other expenses of a personal nature.

SIGNING UP FOR A TRIP

Early reservations are recommended since accommodations often sell out far in advance. Please call 1-800-368-2794 and ask for our Africa Manager or email africa@wildernesstravel.com with any questions that you may have about this trip.

To reserve your Private Journey, we will need to know your preferred dates of travel. We will then check availability and send you a proposed itinerary with exact pricing for your adventure. We can typically hold a provisional booking for one week. At that time, we must collect your initial deposit or accommodations will be released. We accept Visa, Mastercard, or American Express card. Upon receipt of your deposit, we will send you a Welcome Packet that includes a letter of confirmation, Detailed Itinerary, Trip Application, Medical Form, and Pre-Departure Information Booklet with information to help you prepare for your adventure. Please see our Cancellations and Transfer Fee Schedule for specific payment information.

PAYMENT SCHEDULE

At time of reservation: 25%

90 days prior to departure: Balance

CANCELLATION AND TRANSFER FEE SCHEDULE

Minimum fee: 25% of trip cost

90 days or less: 100% of trip cost

*Please note that this differs from our regular catalog departures.

TRAVEL INSURANCE

We highly recommend you purchase travel insurance. You can take advantage of a comprehensive Travel Protection Plan designed for Wilderness Travel by Travelex, or purchase other insurance on your own. See our website for details:

www.wildernesstravel.com/insurance



Private Tented Camps—WT Style

Wilderness Travel's seasonal tented camps are strategically positioned well away from the lodge circuit in locations that put you in the heart of the wildlife action. In addition to offering delightful privacy and a sense of wilderness serenity, the camps pamper you with superb service and delightful amenities. And with a staff to guest ratio of 1:1, you will find them a relaxing oasis after a day on safari. Because the camps are exclusive to our group, you are guaranteed an intimate safari experience where each day's itinerary can adapt as each wildlife viewing experience presents itself.

ELEGANT DINING

Mealtime at our private camps is an unexpected highlight for many guests, with a mouth-watering array of fresh foods and baked goods prepared on site by our great cooks who are easily able to accommodate most diets. Menus

feature expertly prepared dishes like lamb curry, lentil salad with tomatoes and mint, grilled vegetables, and chicken



saltimbocca. Enjoy gourmet picnics beneath the shade of an acacia tree near grazing giraffe, and multi-course meals by candlelight served in our camp's deluxe dining tent. Wherever the meal, you'll feel as if you are in a fine restaurant, while the sights and sounds of the bush remind you that you are on safari!

LIVING UNDER CANVAS

The delightful location of each camp will put you in a romantic world apart. We'll return each day from safari to enjoy stories and laughter around the campfire with a complimentary open bar, before gathering for dinner served in a big, airy open-sided dining tent. Each night you drift to sleep to the enchanting sounds of the African night, enjoying the comforts of your own spacious tent featuring oriental carpets and a real bed (no cots!), along with an en suite bathroom and shower. We achieve all of this with a light environmental footprint—we use rechargeable resources and propane refrigeration instead of noisy generators, and offset all of our fuel usage through a carbon offsetting program.

SPACIOUS TENTS

Your walk-in canvas tent (approximately 30 x 16 feet) is furnished with a king-sized bed (or two singles) cotton duvets, sheets, pillows, and battery-powered lighting. A small veranda at the front has camp chairs, a great place to relax and read.

PRIVATE BATHROOMS

At the rear of the tent is your attached bathroom, with a dressing room, warm-water shower, sink, and toilet.

PERSONAL SERVICE

You'll have your own tent steward, along with complimentary daily laundry service.

WELCOMING CAMP STAFF

Our top-notch camp service is personable and professional, and most of our staff have worked with us for many years. By the end of your stay, they will feel like family and it can feel bittersweet to bid farewell to them as you head back home! Several of our camp watchmen and hiking guides come from local Maasai tribes, so you'll also have the opportunity for fascinating cultural exchanges.

"The wilderness camps, and the staff that ran them, were just spectacular. Everything from fresh coffee brought to the tent every morning to drinks around the fire before dinner to hot showers every evening was just perfect, not to mention the views of the African landscape out the front door, with the only sounds the songs of birds . "

Janet S., Boise, ID

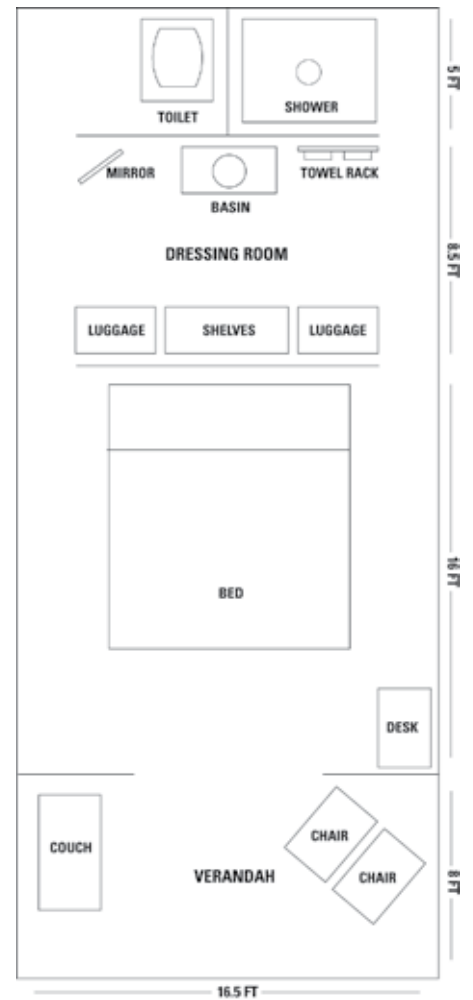

TENT LAYOUT ABOVE IS FOR TARANGIRE; SERENGETI TENTS MEASURE 30' X 14.5'



Accommodations

DAY 1 (1 NIGHT) & DAY 10 (DAY ROOM): ARUSHA, TANZANIA

In Arusha, we stay at one of the following properties based on choice of accommodation (based on group size) and availability:



OLERAI

Once a private home, the Olerai is set on eight acres on the outskirts of Arusha. It welcomes guests with nine en suite rooms spread over the garden grounds. The family-style dining veranda overlooks the manicured lawns, and in the evenings, the fire is lit for socializing over a gin and tonic or regional wine. Mercy, the chef, and her crew prepare delightful cuisine for a farm-to-plate experience with home-grown vegetables and herbs. Olerai provides free Wi-Fi, concierge service, and massage services on request.



THE ARUSHA SERENA HOTEL

Nestled in a coffee plantation on the shores of Lake Duluti, this lodge is a well-run property with an excellent restaurant and a tranquil location. It's a good place to unwind after the long flight to Tanzania. Guest rooms (individual thatch-roofed cottages) are set amid lawns and gardens by the lake. The central dining area, in the style of a country manor house, is a great place to watch the sun go down and have a drink before dinner.



LEGENDARY LODGE(OPTIONAL UPGRADE)

Set in lush tropical gardens on a working coffee farm, Legendary Lodge offers ten garden cottages and two family cottages, each with a private veranda. Rooms are spacious and well appointed, with king size beds, sitting area with fireplace, and en suite bathrooms, with design highlights a unique blend of African arts and crafts and colonial-style luxury. It's an ideal place to relax—time permitting, take advantage of the spa and enjoy a rejuvenating massage!

DAYS 2 TO 4 (3 NIGHTS): TARANGIRE NATIONAL PARK, TANZANIA



OSUNYAI LAMARKAU

Set beneath mature acacia trees and facing the rising sun, Osunyai offers all the creature comforts of a seasonal camp, while retaining the relaxed casual feel of a mobile camp. Luxury safari tents are set to maximize the view in front of camp, where game meanders in search of grazing. The tents are large and airy with full-width windows and en suite bathrooms, king-size double or two extra long single beds, hanging wardrobe, luggage racks, and interior solar light tables. Each has a private veranda. A very large tent forms the nucleus of the camp, an ideal spot to relax and enjoy the tranquil ambiance. In the dining area, you can enjoy delicious meals, sample wines from South Africa and beers from the region, as well as the normal selection of soft drinks, juices, and spirits.

DAY 5-6: NGORONGORO CRATER, TANZANIA



PLANTATION LODGE

With 16 lovely cottages spread out across flowering gardens and located near the Ngorongoro Crater, this elegant lodge has a peaceful setting and is in fact a working coffee plantation. The lodge offers very comfortable and nicely decorated rooms with en suite bathroom, a small sitting area, and a spacious veranda overlooking the gardens, which provide many of the vegetables and fruits served in the restaurant. There is a welcoming bar with a good wine list and the staff offers complimentary appetizers on the terrace before dinner. Or, enjoy a sundowner by the pool!

DAY 7-9: SERENGETI MIGRATION CAMP, TANZANIA



PRIVATE WILDERNESS TRAVEL CAMPS

Our private camps are set in exquisite locations with fantastic access to the wildlife. At Dulana, views look out onto across a shallow valley, where many species of animals can be spotted, and our camp at Akiba Kibwe lies directly in the path of migrating wildebeest and zebra as they head toward the Mara River. Both camps feature large, walk-in tents furnished with bright fabrics and hardwood furniture. Each tent is about 10 by 14 feet with twin beds (or one queen bed), en suite shower and toilet, and full-length windows that offer fine views of the surrounding wilderness right from bedside. In front is a small veranda with two chairs, a small table, and a wash basin. Dinner is served al fresco or in a large dining tent under a big shade tree, and dinners are complete with flatware, china, glasses, and complimentary wine and beer. Because we use rechargeable resources and propane refrigeration at camp, no noisy generators spoil the sound of the African wilds.

These are our signature accommodations for this trip. Although it is highly unlikely, we may make substitutions when necessary. To see more photos and descriptions, please visit our *Tanzania Private Safari* webpage and click on “Accommodations.”



Private Safari Vehicles

Wilderness Travel's primary vehicles for this safari are Toyota Land Cruisers, renowned for being the most rugged and reliable 4X4 safari vehicles in the world. They excel in off-track terrain and each has been custom-modified with Volvo seats that offer adjustable lumbar support. With a maximum of just five guests per vehicle, each passenger is guaranteed his or her own window seat and ample room to stretch out—both for your legs and your camera gear! And best of all, the drivers are under no mileage restrictions—they will go where the wildlife viewing is best, and are under no pressure to limit their route to save gas, as is common in cheaper safaris, especially those using the cramped mini-vans that can't go off-road.

OUR VEHICLES HAVE BEEN EQUIPPED WITH:

- A separate game viewing hatch above each row of two seats. This allows you delightful personal space with unobstructed views and an ideal vantage for getting great photos.
- Air conditioning as needed during warmer seasons when the hatches are closed (usually when traveling at higher speeds or when dusty or raining).
- A shade awning, also available on game drives as needed. The awning allows more than sufficient head room for standing in the open hatch or even sitting on the roof when the vehicle is stationary.
- Bean bags to help steady your longer lenses and get perfect wildlife shots.
- Multiple US-style outlets for recharging your batteries and other devices.
- An Engle Fridge with cold drinks and snacks.
- Refillable water bottles and thermos bottles of tea/coffee
- VHF Radio for communication between vehicles and HF Radio for long distance communication back to the Arusha office.
- On-board library, including field guides and maps of Tanzania and the national parks.
- First-aid kit.
- Fire extinguisher and comprehensive spares and tools.

"OPEN" SAFARI VEHICLES

At our Osunyai Lamarkau Camp in Tarangire, we will enjoy our daily game drives in "open" safari vehicles. These are rugged Land Cruisers, but we've stripped the walls and roof off the chassis to allow you to feel that there is nothing between you and the sights, sounds, and smells of Tanzania. It's a delightful experience and it offers excellent game viewing as the seating is gradually tiered, with the back rows higher than the front—similar to theater seating. There is an awning overhead to offer sun protection. Obviously, an open vehicle like this is only appropriate when the weather is good and there is no need to travel at fast speeds.



Our Guides

MAKE ALL THE DIFFERENCE

The skilled guides at Wilderness Travel transform your safari from amazing to absolutely life-changing. As you look for game alongside these delightful masters of safari, you will be astounded by their vast knowledge, keen eyes (how do they see so incredibly far?), boundless energy, and warm personalities. Our extraordinary guides are a vital component of this adventure. They focus on all the details, from keeping you safe in the bush to finding wildlife in places our untrained eyes would miss, answering your every question, and even helping you set up your camera for the best shot. All native Tanzanians who have been with WT for years, they have an immense love for their country and a belief in the positive impact safaris can bring to supporting conservation. They are the true treasures of our safari, and you will certainly leave the trip calling them not just “friends,” but “family.” Here are a few of our fantastic guides.



NAIMAN MUNGURE

Naiman Mungure, a graduate of the National Outdoor Leadership School (NOLS), has been leading wildlife safaris for nearly two decades. Whether strolling among riverine forests in search of rare birds or navigating his way across the short grass plains of the Serengeti, Naiman has a sense of what makes a great safari experience and ensures that all his guests leave Tanzania with a new insight into the wonders of his native country. His quiet personality and depth of knowledge make him one of our most likeable guides. Naiman is married and has three daughters and one son. When not on safari, he enjoys looking after his farm in Babati, northeast of Arusha.



GOODLUCK URASSA

Goodluck Kilesi Urassa, known as Urassa, is a member of the Meru tribe from the southern slopes of Mount Meru, near Arusha. Early on, he developed a desire to become a guide, and after attending Mount Meru Tour Guiding College, he soon entered the safari profession, rising through the positions of camp crew, support vehicle driver, assistant guide, and now safari guide. His interests include mammal behavior, a particular favorite, and ornithology, a close second. Urassa gives back to his community by doing environmental work in his home area, for example, planting indigenous trees with school children on the slopes of Mount Meru, and educating them about environmental issues. Urassa has a keen spotter’s eye, a love of the bush, and a wit and gentle manner that make him a great safari companion. He lives near his home village with his wife Stella and his three children.

Extend Your Adventure

To help you make the most of your adventure, we've created several exciting trip extensions. For detailed information, including full itineraries and complete pricing, please visit our *Tanzania Private Safari* webpage and click on the "Extensions" tab: www.wildernesstravel.com/trip/tanzania/tanzania-private-journey/extensions



GORILLA TRACKING IN RWANDA'S PARC NATIONAL DES VOLCANS EXTENSION

Join your ranger-guide for the exhilarating experience of tracking and observing the mountain gorilla clans that reside in the spectacular montane forests of Parc National des Volcans, where researcher Dian Fossey was based for 13 years. The hiking terrain ranges in altitude from 3,800 to 8,500 feet and preserves one of the largest natural forests in East Africa. *5 days. From \$3795.*



ZANZIBAR EXTENSION

Just 22 miles off the coast of Tanzania lies the spice-scented isle of Zanzibar, with its ancient Swahili-Arab culture. For centuries, the Sultans of Oman ruled this tiny island and the Arabic influence is still very strong. Snorkeling, diving, bicycling, windsurfing, and the amenities of the resort's spa are just a few of the many optional activities available. Accommodations in Stone Town are at the Serena Inn; on Days 2-3, enjoy the relaxing atmosphere and the sounds and sights of the Indian Ocean with a stay at The Palms or upgrade to the elegant Baraza Resort and Spa. Early booking is recommended due to limited availability.

4 days. From \$2595.

MASAI MARA NATIONAL RESERVE EXTENSION

Set at an altitude of about 5,000 feet, the Masai Mara National Reserve is breathtakingly beautiful with the wide Mara River, one of Kenya's largest rivers, snaking through its green, tree-studded grasslands. The river is home to many hippos and enormous groups of elephant that wander through the lush marshes along the river's edge. Among the plains game found in the Mara are eland, topi, zebra, giraffe, and Thompson's and Grant's gazelle, and buffalo graze here in abundance. There are also some of the rare and endangered black rhino, not always easy to find but a wonderful sight when encountered. The Mara is one of the best places in Kenya to see lion, as there are numerous roaming prides.

Please note: Naibor, Rekeru, and Mara Plains camps are small and exclusive and often fill well in advance; early booking is recommended. There is a 33-lb. weight limit on flights to/from the Masai Mara.

4 days. From \$5695.

Arrival & Departure

ARRIVAL & DEPARTURE

Upon confirming your trip reservation, we will send you a Welcome Packet that includes a list of documents (passport, visas, etc.) required for your trip. Please feel free to call if you would like this information before making your air arrangements.

Arusha, Tanzania, is the meeting and end point for the trip on Day 1. At the end of the trip, you will be transferred to the Kilimanjaro Airport for homeward-bound flights.

FLIGHT ARRANGEMENTS

Trip members are responsible for making their own arrangements for air transportation. Please do not purchase your airline tickets until you are confirmed on the trip and have reviewed your proposed air schedule with our office.

There are many online consolidators for booking travel, but for more personal help arranging air transport, you can contact Exito Travel at 1-800-655-4053 in the US or 1-800-670-2605 in Canada. They are very adept at putting flight itineraries together, to even the most far-flung places. More information can be found on Exito's website at www.exitotravel.com.

Once your tickets have been purchased, please send us a copy of your airline schedule so that we can send it on to the local guide (make sure to include your Trip Name and Trip Dates on it). Note: The name on your airline ticket must match the name on your passport exactly; otherwise you may be denied boarding. Please remember this when reserving your flights. In addition, your passport must be valid for at least six months after your date of return to the US (in most cases).



What to Expect

WHAT THE TRIP IS LIKE

This trip is Level 2, according to the Wilderness Travel trip rating system. It is a camping and lodge safari with game viewing by 4WD vehicle. It can be enjoyed by anyone in reasonably good health. On safari, there are long driving days over rugged dirt tracks.

WEATHER

Tanzania lies close to the equator, so seasonal variations in temperature are not extreme. June, July, and August are the coolest months in East Africa, with lows around 40° and highs of 70°-80°. In Ngorongoro and the Serengeti in these months, you may want to bring a set of long underwear, down vest, or extra sweater for chilly mornings and evenings. September, October, and November are warmer, with lows around 65° and highs of 75°-85°. Scattered rains occur in November and early December, which helps to lay the dust. December to March are the East Africa's warmest season, with daytime temperatures from 80°-90° and evenings from 50°-60°. Avoid April and May, the rainy season. Zanzibar has ideal vacation weather, warm and sunny year-round except April and May (the rainy season). Daytime temperatures are in the 75°-85° F zone, cooled by sea breezes.

GAME DRIVES & WILD ANIMALS

Game drives are in 4WD Land Cruisers with guaranteed window seating (maximum of 5 passengers per vehicle)—there's no taking turns for the window seats. At Alamana and Osunyai, we also enjoy the freedom of exploration in open 4WD vehicles. A cooler of drinks and refreshments is carried aboard, along with a library of field guides and maps. We also do extensive gameviewing while traveling between game

parcs. Often, our Land Cruisers will split up in the parks to track game separately (each vehicle has a sophisticated radio system). Our 4WD vehicles can go virtually anywhere, an important feature when we're tracking game, and they add a sense of adventure to your African safari.

During drives, we can at times get quite close to wild animals. Being very quiet improves everybody's chances of observation. In the interest of safety, your Trip Leader explains limitations on movement while on game drives, in the safari vehicles, and around camp. Incidents with wild animals are extremely rare on safaris, but no camping safari can guarantee immunity from such incidents. Wilderness Travel is not to be held responsible for incidents involving the behavior of wildlife.

WALKING IN PARKS AND RESERVES

You will be able to walk where it is possible (and at additional cost), but this is often determined by local area and by government regulations. Please note that walking in a wildlife area is at your own risk as it can bring you close to dangerous wild animals.

PROTECTING THE SERENGETI ECOSYSTEM

Wilderness Travel is proud to be a founding member of the Friends of Serengeti, which brings together travel companies and travelers to build support, advocacy, and funding for the Serengeti ecosystem in both Tanzania and Kenya. Without our support, the Serengeti, Masai Mara, and surrounding protected areas are in danger of being lost forever. We believe that the success of sustainable tourism will be the deciding factor in whether the Serengeti ecosystem will survive, and a key element is bringing tangible social and economic benefits from tourism to local people. You will be provided with an

Average Daily Max/Min °F												
	Jan	Feb	Mar	Apr	May	Jun	Jul	Aug	Sep	Oct	Nov	Dec
Arusha	84/59	86/59	84/61	79/63	75/61	73/57	73/55	75/55	79/57	82/59	82/61	82/61
Ngorongoro	73/50	73/50	72/50	70/52	68/50	66/46	66/46	68/46	70/46	72/48	72/50	72/50
Serengeti	82/59	82/59	82/59	79/61	79/59	77/57	77/55	79/57	79/57	82/59	81/59	81/59
Tarangire	84/61	86/61	84/63	81/64	77/63	75/57	75/57	77/57	81/59	84/61	84/63	84/63
Rainfall - Inches												
Arusha	2.5	2.5	5.7	13.3	6.7	1.5	0.8	0.6	0.6	1.5	5.0	3.6
Ngorongoro	4.3	3.5	5.4	8.4	3.9	0.9	0.5	0.6	0.4	2.2	4.5	5.4
Serengeti	3.2	3.9	4.8	5.4	2.7	0.9	0.4	0.7	1.3	2.0	3.9	3.8
Tarangire	3.1	3.6	5.2	7.0	1.9	0.2	0.0	0.0	0.1	0.6	3.0	3.7

opportunity to make an optional donation to Friends of Serengeti at the time of your final payment. We also support other organizations working in Africa, including the Jane Goodall Institute, the Cheetah Conservation Fund, and Save the Elephants. [Download more information here.](#)

PRIVATE JOURNEY GUIDED SERVICES

You will have a private safari guide from Day 2 to 8. They are all keen, experienced conservationists. Please note that if our private camps are not available, we may book alternate lodges where you will join other guests for the guided safari activities. There are usually several guides at camp, so the size of your gameviewing group will be small. Our guides will try their best to accommodate any special interests you may have.

CHOOSING THE RIGHT TRIP

Adventure travel often involves exotic destinations, unusual levels of physical exertion, or activities you may not have participated in previously. We work hard to help you choose the right trip for you, paying attention to your individual interests, abilities, and needs. If you have questions about the level of comfort or any of the activities described in this itinerary, please call Wilderness Travel at 1-800-368-2794 and ask for the Africa Manager or email us at africa@wildernesstravel.com.

REFERENCES

We'd be happy to put you in touch with a past client that has traveled with us on this or a similar trip.

ABOUT PRIVATE JOURNEYS

Wilderness Travel Private Journeys are designed for people who want to travel with their own small private group, but who still want to experience the same superb itinerary design, great accommodations, and signature quality of Wilderness Travel's escorted group trips. These Private Journeys allow you to choose your own dates and your traveling companions, yet still enjoy a guided adventure.

VISIT OUR WEBSITE

At www.wildernesstravel.com, you can find out about added departures, last-minute deals, and special WT Expeditions that aren't listed in our catalog. You can also access a complete library of our detailed itineraries and browse the customized reading guides for each of our adventures.





WILDERNESS TRAVEL HAS BEEN AWARDED:

Best Travel Specialists in the World: *Conde Nast Traveler*, 2024, 4-time winner

World's Best Tour Operators: *Travel + Leisure*, 11-time winner

Best Wildlife, Hiking & Walking Trips: *AFAR Magazine*, 3 years in a row

Best Adventure Travel Companies: *USA Today*

Trip of the Year: *Outside Magazine*, 9-time winner

50 Tours of a Lifetime: *National Geographic Traveler*, 9 years in a row

Best Adventure Travel Companies: *National Geographic Adventure*, 3-time winner

Please be advised that California has established a Travel Consumer Restitution Fund under the California Seller of Travel Law that took effect January 1, 1996. This fund is designed to protect consumers from unscrupulous practices by discount airfare ticket sellers or air charter operators. Unfortunately, this law does not cover non-California residents and, even in the case of California residents, it does not cover any foreign travel where the foreign "providers of transportation or travel services" are not in compliance with the Sellers of Travel Law (compliance being defined as registered as a Seller of Travel in California and a participant in the Travel Consumer Restitution Fund). Thus none of Wilderness Travel's tours qualify and we are required by law to advise each client that they are not covered by the California Travel Consumer Restitution Fund. California law requires sellers of travel to maintain a trust account or bond. This business has a trust account. California Seller of Travel #100769640

While as accurate as possible at the time of printing, this itinerary should be considered an approximate indication of the schedule and scope of activities and trip routing, rather than an inflexible schedule of events; it is subject to change due to circumstances beyond our control. This trip is subject to the Limitation of Liability and all the terms and conditions as detailed in the General Information section of the Wilderness Travel Catalog.

Revised: July 19, 2024 3:02 PM



1102 Ninth Street, Berkeley, CA 94710

800-368-2794 • 510-558-2488

www.wildernesstravel.com • info@wildernesstravel.com