

Tanzania Family Private Safari

LEGENDARY SERENGETI AND TARANGIRE NATIONAL PARK



Wilderness Travel



Tanzania Family Private Safari

WHEN TO GO

December to March
June to October

ABOUT PRIVATE JOURNEYS

Wilderness Travel Private Journeys are designed for people who want to travel with their own small private group, but who still want to experience the same superb itinerary design, great accommodations, and signature quality of Wilderness Travel's escorted group trips. These Private Journeys allow you to choose your own dates and your traveling companions yet still enjoy a guided adventure.

Contact us for availability, questions, or to book your adventure!

With its world-renowned game reserves, home to some of the largest concentrations of wildlife anywhere in the world, and its rich culture and welcoming people, including the legendary Maasai of the Serengeti, Tanzania is the perfect place for a fantastic family safari. We bring you to two of its world-renowned sanctuaries—Tarangire National Park, whose migrating wildlife is drawn by the permanent waters of the Tarangire River, and the famed Serengeti, where the earth's greatest gathering of terrestrial wildlife roams freely on golden savannas. Expert private naturalist guides, exciting game drives, fantastic private camps, and special activities for kids—including Swahili lessons, perfectly paced bush walks, and Maasai storytelling and jumping competitions—combine to make this the quintessential family safari. You can add extra days at each camp if you like, and post-trip, enjoy a visit to the paradisiacal island of Zanzibar, Ngorongoro Crater, Kenya's Masai Mara National Reserve, or track gorillas in Rwanda.



The Serengeti Migration

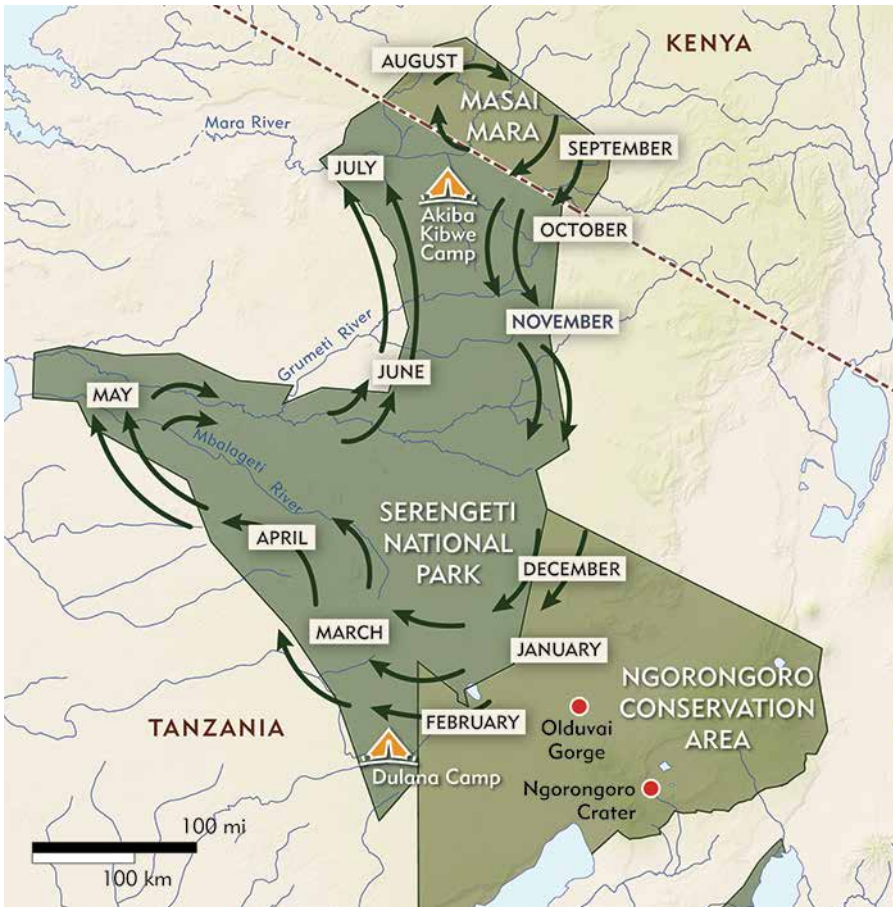

WHAT IS THE GREAT MIGRATION?

The Great Migration is the largest mass movement of land mammals on Earth, when more than a million wildebeest—along with hundreds of thousands of zebra and gazelle, stalked by predators like big cats and hyenas—circle through the Serengeti plains in Tanzania and Masai Mara Reserve in Kenya. Following instinct and the scent of moisture, the herds move clockwise from their calving grounds in the lush plains of the southern Serengeti, moving to the northern Serengeti as the plains dry out, and spending the summer and early fall here before heading south again in the fall to repeat the cycle. The scale of this event, and the encounters between predator and prey, offer an extraordinary and unequalled wildlife spectacle. Witnessing it firsthand is an awe-inspiring privilege.





Itinerary

TRIP DETAILS AT-A-GLANCE

- Length:** 8 days
- Arrive:** Arusha, Tanzania
- Depart:** Arusha, Tanzania
- Lodging:** 6 nights private tented camps, 1 night lodge or hotel
- Meals:** All meals included (B=Breakfast, L=Lunch, D=Dinner)
- Activity:** Cultural Adventures, Safaris
- Trip Level:** 1 2 3 4 5 6
Game viewing by open 4WD vehicle, optional game walks

DAY 1 ARRIVE IN ARUSHA, TANZANIA

Late evening arrival at Kilimanjaro Airport near Arusha. You will be met and transferred to the Olerai, a guesthouse set in tranquil flowered gardens. Dinner and overnight at the lodge...D

DAYS 2-4 ARUSHA / FLY TO TARANGIRE NATIONAL PARK

The morning is at leisure in Arusha, with lunch at the lodge. An optional village walk is available. In the afternoon, take a scheduled charter flight to Tarangire National Park, where you meet your private safari guide and vehicle for a transfer to camp, enjoying a game drive en route.

The thousand-square-mile Tarangire region is a haven for wildlife with an extremely rich game viewing potential: herds up to 300 elephants scratch the dry river bed for underground streams, while migratory wildebeest, zebra, buffalo, impala, gazelle, hartebeest, and eland crowd the shrinking lagoons. It has the greatest concentration of wildlife outside the Serengeti ecosystem, and the one place in Tanzania where dry-country antelope such as the oryx and the renyuk are regularly observed. In addition to daytime game drives in this slice of untamed Tanzania, our camp offers night drives and bush walks. You will also have a special Maasai Olpul ceremony at the camp, with opportunities to learn more about the Maasai way of life. Also included is a guided nature walk near camp to learn how the Maasai use the local plants. Overnight at your private camp at Osunyai Lamarkau (note that with groups of four or fewer, we do not guarantee exclusive use of the camp, but you will have your own private guide and vehicle)...BLD each day



Kids' Activities Available at Your Private Camp in Tarangire National Park:

- **Cooking:** Learn how to make Loshoro, a favorite Maasai soup or drink made with maize and milk) with Marko, our resident Maasai cook
- **Footprint Walk:** See how the Maasai identify animals by their paw prints and other signs
- **Medicinal Walk with Maasai:** Learn how the Maasai use some of the plants of the bush for medicinal purposes. Both the Medicinal Walk and Footprint Walk will be carried out around camp (full-fledged bush walks are not available to children under 16)
- **Maasai Olpul:** A traditional Maasai ceremony, with a jumping competition
- **Night Game Drives:** Head out with the guides to look for nocturnal wildlife using a spotlight
- **Bao:** Learn to play Bao, the traditional board game of the Swahili people of Tanzania (can also be done at your Serengeti camp)

DAYS 5-7 SERENGETI PRIVATE CAMP

Transfer to the airstrip for a scenic flight to the Serengeti. Upon arrival meet your second private guide and drive to your private camp in the Serengeti with game drive and picnic lunch enroute. You'll enjoy your own exclusive camp in a secluded section of the park, far from the lodges and other park facilities. Dawn and late-afternoon game drives bring you from the open plains and rock kopjes to river habitats, as game conditions dictate.

The Maasai, who have grazed their cattle on the vast grassy plains of Serengeti for millennia before it became a park, call it Siringitu, "the place where the land moves on forever." Today, Serengeti National Park, along with the Ngorongoro Conservation Area and Maasai Mara National Reserve across the border in Kenya, protects the greatest and most varied collection of terrestrial wildlife on earth as well as one of the world's last great migratory systems. The park itself is 5,700 square miles, with open, grassy plains in the south, acacia-dotted savanna in the center, and black clay plains to the west. You should see vast numbers of migrating wildebeest and zebra, along with Serengeti's resident wildlife, including giraffe, buffalo, waterbuck, hippopotamus, crocodile, warthog, and diverse birdlife. Large prides of lion reside here, as well as clans of spotted hyena. The river tracks offer the best chance to see a leopard, usually in the branches of acacia or sausage



trees. Cheetah can also be seen here as well as serval and caracal, two smaller African cats.

Overnights at Dulana Camp or Akiba Kibwe Camp, depending on the season (Note: with groups of four or fewer at these two camps, we do not guarantee exclusive use of the camp, but you will have your own private guide and vehicle)... BLD each day

Kids' Activities Available at Your Private Camp in the Serengeti:

- Star Gazing at Camp: Learn how to identify the constellations and legends behind them (there are many tribes here so local legends and myths will be brought up)
- Say It in Swahili: Casual/fun interactive Swahili lessons/ words. There will be storytelling of a traditional Tanzanian legend by one of your Maasai guides
- Wildlife Quiz: At the end of the safari, test your knowledge of the wildlife with your guide

Note: On June-October departures, your safari will explore the northern section of the Serengeti. The diminished grasslands at this time of year force the herds to the very edge of the Serengeti/Mara border, and your camp lies directly in the route of the migrating wildebeest and zebra as they head toward the Mara River. On December-March departures, our camp is in the southern section of the Serengeti, where animals graze on lush green grass during this green season.

Optional Add-On:

Extra Days at Tarangire or in the Serengeti. See Trip Cost section for additional costs.

DAY 8 ARUSHA / DEPART

A scheduled charter flight brings you from the Serengeti to Arusha, where lunch is arranged for you and day rooms are held at the Olerai. Enjoy a range of activities before your evening flight. Options include a shopping excursion in Arusha, visit an African art gallery, an opportunity to learn to make Ugali, a traditional Tanzanian dish, or to make a beaded Maasai anklet bracelet with a Maasai woman from a nearby village (takes about two hours) or get a traditional temporary tattoo of henna ink. Depart Tanzania in the evening, or join one of our many optional trip extensions...BL

Trip Details

PRICING INFORMATION

TRIP COST

Prices are per person, valid through 2025

\$7,595 (9-14 members)

\$7,995 (4-8 members)

Single supplement: \$485

Internal airfare: \$1,015 (subject to change)

Park Fees: \$1,590

Child discount (under 16): \$1,000

Note. We need a minimum of 4 trip members to run the trip.

Prices are based on double occupancy and not guaranteed until services are confirmed.

Make it Your Trip!

The prices above are for the ready-to-book adventure outlined in this Detailed Itinerary, a popular option that has been handcrafted by our Area Specialists to include the best of every destination. While many travelers choose to book this tour as is, our Area Specialists are also happy to work with you to customize this Private Journey to suit your specific interests and style of travel. We can arrange for longer or shorter stays, or add an extension to additional places of interest. We can even add special activities or customize excursions depending on your interests. We invite you to contact us to discuss your options!

TRIP COST INCLUDES

- Accommodations as noted in the Detailed Itinerary, based on double occupancy
- All meals as noted in Detailed Itinerary
- Services of safari guides and camp staff
- 4WD safari vehicles
- Land and internal air transportation as noted
- All airport transfers and airport assistance at Kilimanjaro Airport
- Night game drives, bush/nature walks and Maasai cultural activities are included at Osunyai Lamarkau

TRIP COST DOES NOT INCLUDE

International airfare, any meals not specified after each itinerary day, any activities described as optional, airport departure taxes, optional tipping or gratuities to staff, additional hotel nights made necessary by airline schedule

changes or other factors, pre-trip expenses such as medical immunizations (if any), travel insurance, or passports and visas; and other expenses of a personal nature.

SIGNING UP FOR A TRIP

Early reservations are recommended since accommodations often sell out far in advance. Please call 1-800-368-2794 and ask for our Asia Manager or email us at asia@wildernesstravel.com with any questions that you may have about this trip. To reserve your Private Journey, we will need to know your preferred dates of travel. We will then check availability and send you a proposed itinerary with exact pricing for your adventure. We can typically hold a provisional booking for one week. At that time, we must collect your initial deposit or accommodations will be released. We accept Visa, Mastercard, or American Express card. Upon receipt of your deposit, we will send you a Welcome Packet that includes a letter of confirmation, Detailed Itinerary, Trip Application, Medical Form, and Pre-Departure Information Booklet with information to help you prepare for your adventure. Please see our Cancellations and Transfer Fee Schedule for specific payment information.

PAYMENT SCHEDULE

At time of reservation: 25%

90 days prior to departure: Balance

CANCELLATION AND TRANSFER FEE SCHEDULE

Minimum fee: 25% of trip cost

90 days or less: 100% of trip cost*Please note that this differs from our regular catalog departures.

TRAVEL INSURANCE

We highly recommend you purchase travel insurance. You can take advantage of a comprehensive Travel Protection Plan designed for Wilderness Travel by Travelex, or purchase other insurance on your own. See our website for details: <http://www.wildernesstravel.com/toucan/travel-insurance>

Extend Your Adventure

To help you make the most of your adventure, we've created several exciting trip extensions. For detailed information, including full itineraries and complete pricing, please visit our *Tanzania Family Private Safari* webpage and click on the "Extensions" tab: www.wildernesstravel.com/trip/tanzania/family-safari-serengeti-private-journey/extensions



ZANZIBAR EXTENSION

Just 22 miles off the coast of Tanzania lies the spice-scented isle of Zanzibar, with its ancient Swahili-Arab culture. For centuries, the Sultans of Oman ruled this tiny island and the Arabic influence is still very strong. Snorkeling, diving, bicycling, windsurfing, and the amenities of the resort's spa are just a few of the many optional activities available. Accommodations in Stone Town are at the Serena Inn; on Days 2-3, enjoy the relaxing atmosphere and the sounds and sights of the Indian Ocean with a stay at The Palms or upgrade to the elegant Baraza Resort and Spa. Early booking is recommended due to limited availability.

4 days. From \$2595.



GORILLA TRACKING IN RWANDA'S PARC NATIONAL DES VOLCANS EXTENSION

Join your ranger-guide for the exhilarating experience of tracking and observing the mountain gorilla clans that reside in the spectacular montane forests of Parc National des Volcans, where researcher Dian Fossey was based for 13 years. The hiking terrain ranges in altitude from 3,800 to 8,500 feet and preserves one of the largest natural forests in East Africa.

5 days. From \$3795.

MASAI MARA NATIONAL RESERVE EXTENSION

Set at an altitude of about 5,000 feet, the Masai Mara National Reserve is breathtakingly beautiful with the wide Mara River, one of Kenya's largest rivers, snaking through its green, tree-studded grasslands. The river is home to many hippos and enormous groups of elephant that wander through the lush marshes along the river's edge. Among the plains game found in the Mara are eland, topi, zebra, giraffe, and Thompson's and Grant's gazelle, and buffalo graze here in abundance. There are also some of the rare and endangered black rhino, not always easy to find but a wonderful sight when encountered. The Mara is one of the best places in Kenya to see lion, as there are numerous roaming prides.

Please note: Naibor, Rekeru, and Mara Plains camps are small and exclusive and often fill well in advance; early booking is recommended. There is a 33-lb. weight limit on flights to/from the Masai Mara. *4 days. From \$5695.*



Ngorongoro Crater Extension

Visit the famed wildlife haven of Ngorongoro Crater, with its 2,000-foot-high walls and nearby tribal communities. On the 105-square-mile crater floor, you'll find elephant, zebra, wildebeest, buffalo, and endangered black rhino. While at Ngorongoro, you'll have the option to visit to the famed paleoanthropological site of Olduvai Gorge, dubbed "the Cradle of Mankind." The extension also includes an option to visit to the traditional Datoga tribe near Lake Eyasi and time to and explore the subtropical forests of Lake Manyara National Park, home to troops of baboons and monkeys plus a wealth of exotic birdlife.

DAY 1 NGORONGORO CONSERVATION AREA / PLANTATION LODGE

Join your private guide and drive to the Ngorongoro Highlands with game viewing en route to Plantation Lodge, a small, secluded property conveniently located near the Ngorongoro Conservation Area and Lake Manyara. After you settle in, enjoy a walk around the lodge's gorgeous gardens, a dip in the pool, or an optional visit to a nearby farm to learn about the working lives of the local people. The lodge's garden offers an opportunity to spot some of the region's colorful birdlife. Overnight at Plantation Lodge...BLD

DAY 2 NGORONGORO CRATER / OLDUVAI GORGE

At 7,300 feet above sea level and enclosed by steep walls, Ngorongoro is the largest unbroken caldera in the world. It is truly one of the wonders of the natural world. Set out for a full-day game drive on the crater floor, with a picnic lunch. As an alternative to a full day in the crater, take the the option to visit the crater in the morning and Olduvai Gorge in the afternoon. Overnight at Plantation Lodge...BLD

DAY 3 DATOGA CULTURAL ENCOUNTER / LAKE MANYARA NATIONAL PARK / TREETOP CANOPY WALK

Options for Day 3:

• Datoga Cultural Encounter

Drive to remote Lake Eyasi, a seasonal soda lake on the floor of the Great Rift Valley, and meet the pastoral Datoga

people, noted traditional blacksmiths and keepers of a distinct language. They have livestock such as cattle, goats, and sheep and make a living by collecting scrap metal and forging it into bracelets, arrowheads, and knives. They consider themselves to be the oldest tribe in Tanzania, with origins dating back 3,000 years.

• Lake Manyara National Park and Treetop Canopy Walk

Head to Lake Manyara National Park for a game drive and canopy walk. Nestled at the base of the Great Rift Valley escarpment, Lake Manyara is one of the most beautiful places in Africa, with lush vegetation that provides home to troops of baboons and blue monkeys. The woodlands, grasslands, wetlands, and the soda lake itself have recorded over 350 species of birds, including flamingo, pelican, sacred ibis, and stork. Included is an hour-long guided walk on the Treetop Canopy for a fascinating birds-eye view of Lake Manyara's rich forest habitats.

Overnight at Plantation Lodge...BLD

DAY 4 DEPART

Depart for your next safari camp...B

2025 EXTENSION COST

\$2995 per person, double occupancy (includes park fees)

Single supplement: \$385

Please note: A 25% non-refundable deposit is required for this extension.

A minimum of 4 trip members is needed to run the extension.

Extension Cost Includes: accommodations, meals as indicated, private guide and vehicle, park fees, airport transfers, and activities as indicated.

Not Included: meals not specified (BLD), items of a personal nature, optional gratuities to guide and lodge staff, additional hotel nights or extra costs that may be necessitated by airline changes or other factors, cost of medical immunizations (if any), travel insurance, visas, and other expenses of a personal nature.



Private Tented Camps—WT Style

Wilderness Travel's seasonal tented camps are strategically positioned well away from the lodge circuit in locations that put you in the heart of the wildlife action. In addition to offering delightful privacy and a sense of wilderness serenity, the camps pamper you with superb service and delightful amenities. And with a staff to guest ratio of 1:1, you will find them a relaxing oasis after a day on safari. Because the camps are exclusive to our group, you are guaranteed an intimate safari experience where each day's itinerary can adapt as each wildlife viewing experience presents itself.

ELEGANT DINING

Mealtime at our private camps is an unexpected highlight for many guests, with a mouth-watering array of fresh foods and baked goods prepared on site by our great cooks who are easily able to accommodate most diets. Menus

feature expertly prepared dishes like lamb curry, lentil salad with tomatoes and mint, grilled vegetables, and chicken



saltimbocca. Enjoy gourmet picnics beneath the shade of an acacia tree near grazing giraffe, and multi-course meals by candlelight served in our camp's deluxe dining tent. Wherever the meal, you'll feel as if you are in a fine restaurant, while the sights and sounds of the bush remind you that you are on safari!

LIVING UNDER CANVAS

The delightful location of each camp will put you in a romantic world apart. We'll return each day from safari to enjoy stories and laughter around the campfire with a complimentary open bar, before gathering for dinner served in a big, airy open-sided dining tent. Each night you drift to sleep to the enchanting sounds of the African night, enjoying the comforts of your own spacious tent featuring oriental carpets and a real bed (no cots!), along with an en suite bathroom and shower. We achieve all of this with a light environmental footprint—we use rechargeable resources and propane refrigeration instead of noisy generators, and offset all of our fuel usage through a carbon offsetting program.

SPACIOUS TENTS

Your walk-in canvas tent (approximately 30 x 16 feet) is furnished with a king-sized bed (or two singles) cotton duvets, sheets, pillows, and battery-powered lighting. A small veranda at the front has camp chairs, a great place to relax and read.

PRIVATE BATHROOMS

At the rear of the tent is your attached bathroom, with a dressing room, warm-water shower, sink, and toilet.

PERSONAL SERVICE

You'll have your own tent steward, along with complimentary daily laundry service.

WELCOMING CAMP STAFF

Our top-notch camp service is personable and professional, and most of our staff have worked with us for many years. By the end of your stay, they will feel like family and it can feel bittersweet to bid farewell to them as you head back home! Several of our camp watchmen and hiking guides come from local Maasai tribes, so you'll also have the opportunity for fascinating cultural exchanges.

"The wilderness camps, and the staff that ran them, were just spectacular. Everything from fresh coffee brought to the tent every morning to drinks around the fire before dinner to hot showers every evening was just perfect, not to mention the views of the African landscape out the front door, with the only sounds the songs of birds . "

Janet S., Boise, ID

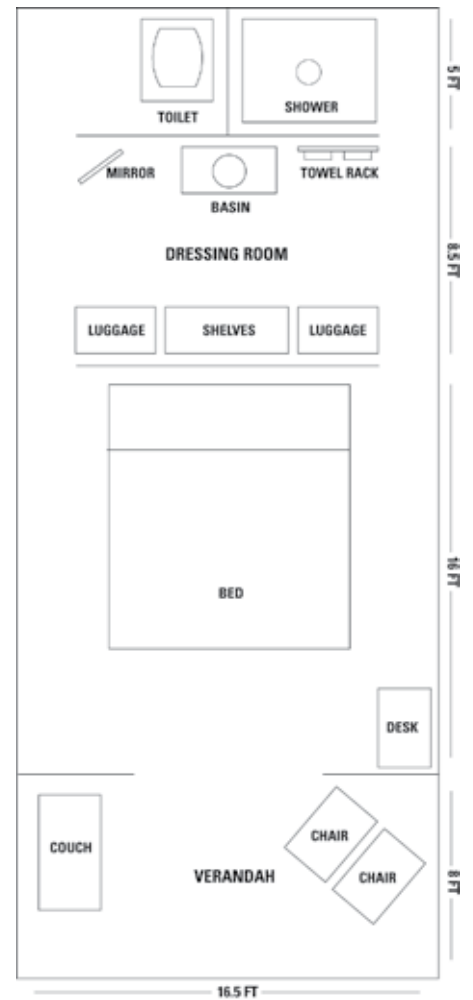

TENT LAYOUT ABOVE IS FOR TARANGIRE; SERENGETI TENTS MEASURE 30' X 14.5'



Lodging



OLERAI

Arusha, Tanzania

Day 1 (1 night), Day 8 (Dayroom)

Once a private home, the Olerai is set on eight acres on the outskirts of Arusha. It welcomes guests with nine en suite rooms spread over the garden grounds. The family-style dining veranda overlooks the manicured lawns, and in the evenings, the fire is lit for socializing over a gin and tonic or regional wine. Mercy, the chef, and her crew prepare delightful cuisine for a farm-to-plate experience with home-grown vegetables and herbs. Olerai provides free Wi-Fi, concierge service, and massage services on request.



OSUNYAI LAMARKAU

Tarangire National Park, Tanzania

Days 2 to 4 (3 nights)

Set beneath mature acacia trees and facing the rising sun, Osunyai offers all the creature comforts of a seasonal camp, while retaining the relaxed casual feel of a mobile camp. Luxury safari tents are set to maximize the view in front of camp, where game meanders in search of grazing. The tents are large and airy with full-width windows and en suite bathrooms, king-size double or two extra long single beds, hanging wardrobe, luggage racks, and interior solar light tables. Each has a private veranda. A very large tent forms the nucleus of the camp, an ideal spot to relax and enjoy the tranquil ambiance. In the dining area, you can enjoy delicious meals, sample wines from South Africa and beers from the region, as well as the normal selection of soft drinks, juices, and spirits.



PRIVATE WILDERNESS TRAVEL CAMPS

Serengeti National Park, Tanzania

Days 5 to 7 (3 nights)

Our private camps are set in exquisite locations with fantastic access to the wildlife. At Dulana, views look out onto across a shallow valley, where many species of animals can be spotted, and our camp at Akiba Kibwe lies directly in the path of migrating wildebeest and zebra as they head toward the Mara River. Both camps feature large, walk-in tents furnished with bright fabrics and hardwood furniture. Each tent is about 10 by 14 feet with twin beds (or one queen bed), en suite shower and toilet, and full-length windows that offer fine views of the surrounding wilderness right from bedside. In front is a small veranda with two chairs, a small table, and a wash basin. Dinner is served al fresco or in a large dining tent under a big shade tree, and dinners are complete with flatware, china, glasses, and complimentary wine and beer. Because we use rechargeable resources and propane refrigeration at camp, no noisy generators spoil the sound of the African wilds.

These are our signature accommodations for this trip. Although it is highly unlikely, we may make substitutions when necessary. To see more photos and descriptions, please visit our *Tanzania Family Private Journey* webpage and click on the “Lodging” tab.



Private Safari Vehicles

Wilderness Travel’s primary vehicles for this safari are Toyota Land Cruisers, renowned for being the most rugged and reliable 4X4 safari vehicles in the world. They excel in off-track terrain and each has been custom-modified with Volvo seats that offer adjustable lumbar support. With a maximum of just five guests per vehicle, each passenger is guaranteed his or her own window seat and ample room to stretch out—both for your legs and your camera gear! And best of all, the drivers are under no mileage restrictions—they will go where the wildlife viewing is best, and are under no pressure to limit their route to save gas, as is common in cheaper safaris, especially those using the cramped mini-vans that can’t go off-road.

OUR VEHICLES HAVE BEEN EQUIPPED WITH:

- A separate game viewing hatch above each row of two seats. This allows you delightful personal space with unobstructed views and an ideal vantage for getting great photos.
- Air conditioning as needed during warmer seasons when the hatches are closed (usually when traveling at higher speeds or when dusty or raining).
- A shade awning, also available on game drives as needed. The awning allows more than sufficient head room for standing in the open hatch or even sitting on the roof when the vehicle is stationary.
- Bean bags to help steady your longer lenses and get perfect wildlife shots.
- Multiple US-style outlets for recharging your batteries and other devices.
- An Engle Fridge with cold drinks and snacks.
- Refillable water bottles and thermos bottles of tea/coffee
- VHF Radio for communication between vehicles and HF Radio for long distance communication back to the Arusha office.
- On-board library, including field guides and maps of Tanzania and the national parks.
- First-aid kit.
- Fire extinguisher and comprehensive spares and tools.

“OPEN” SAFARI VEHICLES

At our Osunyai Lamarkau Camp in Tarangire during the green season, and at Akiba Kibwe during the dry season, we will enjoy our daily game drives in “open” safari vehicles. These are rugged Land Cruisers, but we’ve stripped the walls and roof off the chassis to allow you to feel that there is nothing between you and the sights, sounds, and smells of Tanzania. It’s a delightful experience and it offers excellent game viewing as the seating is gradually tiered, with the back rows higher than the front—similar to theater seating. There is an awning overhead to offer sun protection. Obviously, an open vehicle like this is only appropriate when the weather is good and there is no need to travel at fast speeds.



Our Guides

MAKE ALL THE DIFFERENCE

The skilled guides at Wilderness Travel transform your safari from amazing to absolutely life-changing. As you look for game alongside these delightful masters of safari, you will be astounded by their vast knowledge, keen eyes (how do they see so incredibly far?), boundless energy, and warm personalities. Our extraordinary guides are a vital component of this adventure. They focus on all the details, from keeping you safe in the bush to finding wildlife in places our untrained eyes would miss, answering your every question, and even helping you set up your camera for the best shot. All native Tanzanians who have been with WT for years, they have an immense love for their country and a belief in the positive impact safaris can bring to supporting conservation. They are the true treasures of our safari, and you will certainly leave the trip calling them not just “friends,” but “family.” Here are a few of our fantastic guides.



NAIMAN MUNGURE

Naiman Mungure, a graduate of the National Outdoor Leadership School (NOLS), has been leading wildlife safaris for nearly two decades. Whether strolling among riverine forests in search of rare birds or navigating his way across the short grass plains of the Serengeti, Naiman has a sense of what makes a great safari experience and ensures that all his guests leave Tanzania with a new insight into the wonders of his native country. His quiet personality and depth of knowledge make him one of our most likeable guides. Naiman is married and has three daughters and one son. When not on safari, he enjoys looking after his farm in Babati, northeast of Arusha.



GOODLUCK URASSA

Goodluck Kilesi Urassa, known as Urassa, is a member of the Meru tribe from the southern slopes of Mount Meru, near Arusha. Early on, he developed a desire to become a guide, and after attending Mount Meru Tour Guiding College, he soon entered the safari profession, rising through the positions of camp crew, support vehicle driver, assistant guide, and now safari guide. His interests include mammal behavior, a particular favorite, and ornithology, a close second. Urassa gives back to his community by doing environmental work in his home area, for example, planting indigenous trees with school children on the slopes of Mount Meru, and educating them about environmental issues. Urassa has a keen spotter’s eye, a love of the bush, and a wit and gentle manner that make him a great safari companion. He lives near his home village with his wife Stella and his three children.

Arrival & Departure

ARRIVAL & DEPARTURE

Upon confirming your trip reservation, we will send you a Welcome Packet that includes a list of documents (passport, visas, etc.) required for your trip. Please feel free to call if you would like this information before making your air arrangements.

Arusha, Tanzania, is the meeting and end point for the trip on Day 1. At the end of the trip, you will be transferred to the Kilimanjaro Airport for homeward-bound flights.

FLIGHT ARRANGEMENTS

Trip members are responsible for making their own arrangements for air transportation. Please do not purchase your airline tickets until you are confirmed on the trip and have reviewed your proposed air schedule with our office.

There are many online consolidators for booking travel, but for more personal help arranging air transport, you can contact Exito Travel at 1-800-655-4053 in the US or 1-800-670-2605 in Canada. They are very adept at putting flight itineraries together, to even the most far-flung places. More information can be found on Exito's website at www.exitotravel.com.

Once your tickets have been purchased, please send us a copy of your airline schedule so that we can send it on to the local guide (make sure to include your Trip Name and Trip Dates on it). Note: The name on your airline ticket must match the name on your passport exactly; otherwise you may be denied boarding. Please remember this when reserving your flights. In addition, your passport must be valid for at least six months after your date of return to the US (in most cases).

What the Trip is Like

TRIP LEVEL

This trip is Level 2, according to the Wilderness Travel trip rating system. It is a camping and lodge safari with game viewing by 4WD vehicle. It can be enjoyed by anyone in reasonably good health. On safari, there are long driving days over rugged dirt tracks.

WEATHER

Tanzania lies close to the equator, so seasonal variations in temperature are not extreme. June, July, and August are the coolest months in East Africa, with lows around 40° and highs of 70°-80°. In Ngorongoro and the Serengeti in these months, you may want to bring a set of long underwear, down vest, or extra sweater for chilly mornings and evenings. September, October, and November are warmer, with lows around 65° and highs of 75°-85°. Scattered rains occur in November and early December, which helps to lay the dust. December to March are the East Africa's warmest season, with daytime temperatures from 80°-90° and evenings from 50°-60°. Avoid April and May, the rainy season. Zanzibar has ideal vacation weather, warm and sunny year-round except April and May (the rainy season). Daytime temperatures are in the 75°-85° F zone, cooled by sea breezes.

GAME DRIVES & WILD ANIMALS

Game drives are in 4WD Land Cruisers with guaranteed window seating (maximum of 5 passengers per vehicle)—there's no taking turns for the window seats. At Osunyai, we also enjoy the freedom of exploration in open 4WD vehicles. A cooler of drinks and refreshments is carried aboard, along with a library of field guides and maps. We also do extensive gameviewing while traveling between game parks. Often,

our Land Cruisers will split up in the parks to track game separately (each vehicle has a sophisticated radio system). Our 4WD vehicles can go virtually anywhere, an important feature when we're tracking game, and they add a sense of adventure to your African safari.

During drives, we can at times get quite close to wild animals. Being very quiet improves everybody's chances of observation. In the interest of safety, your Trip Leader explains limitations on movement while on game drives, in the safari vehicles, and around camp. Incidents with wild animals are extremely rare on safaris, but no camping safari can guarantee immunity from such incidents. Wilderness Travel is not to be held responsible for incidents involving the behavior of wildlife.

WALKING IN PARKS AND RESERVES

You will be able to walk where it is possible (and at additional cost), but this is often determined by local area and by government regulations. Please note that walking in a wildlife area is at your own risk as it can bring you close to dangerous wild animals.

PROTECTING THE SERENGETI ECOSYSTEM

Wilderness Travel is proud to be a founding member of the Friends of Serengeti, which brings together travel companies and travelers to build support, advocacy, and funding for the Serengeti ecosystem in both Tanzania and Kenya. Without our support, the Serengeti, Masai Mara, and surrounding protected areas are in danger of being lost forever. We believe that the success of sustainable tourism will be the deciding factor in whether the Serengeti ecosystem will survive, and a key element is bringing tangible social and economic benefits from tourism to local people. You will be provided with an

Average Daily Max/Min °F												
	Jan	Feb	Mar	Apr	May	Jun	Jul	Aug	Sep	Oct	Nov	Dec
Arusha	84/59	86/59	84/61	79/63	75/61	73/57	73/55	75/55	79/57	82/59	82/61	82/61
Ngorongoro	73/50	73/50	72/50	70/52	68/50	66/46	66/46	68/46	70/46	72/48	72/50	72/50
Serengeti	82/59	82/59	82/59	79/61	79/59	77/57	77/55	79/57	79/57	82/59	81/59	81/59
Tarangire	84/61	86/61	84/63	81/64	77/63	75/57	75/57	77/57	81/59	84/61	84/63	84/63
Rainfall - Inches												
Arusha	2.5	2.5	5.7	13.3	6.7	1.5	0.8	0.6	0.6	1.5	5.0	3.6
Ngorongoro	4.3	3.5	5.4	8.4	3.9	0.9	0.5	0.6	0.4	2.2	4.5	5.4
Serengeti	3.2	3.9	4.8	5.4	2.7	0.9	0.4	0.7	1.3	2.0	3.9	3.8
Tarangire	3.1	3.6	5.2	7.0	1.9	0.2	0.0	0.0	0.1	0.6	3.0	3.7

What the Trip is Like (cont'd)

opportunity to make an optional donation to Friends of Serengeti at the time of your final payment. We also support other organizations working in Africa, including the Jane Goodall Institute, the Cheetah Conservation Fund, and Save the Elephants. [Download more information here.](#)

PRIVATE JOURNEY GUIDED SERVICES

You will have a private safari guide from Day 2 to 8. They are all keen, experienced conservationists. Please note that if our private camps are not available, we may book alternate lodges where you will join other guests for the guided safari activities. There are usually several guides at camp, so the size of your gameviewing group will be small. Our guides will try their best to accommodate any special interests you may have.

CHOOSING THE RIGHT TRIP

Adventure travel often involves exotic destinations, unusual levels of physical exertion, or activities you may not have participated in previously. We work hard to help you choose the right trip for you, paying attention to your individual interests, abilities, and needs. If you have questions about the level of comfort or any of the activities described in this itinerary, please call Wilderness Travel at 1-800-368-2794 and ask for the Africa Manager or email us at africa@wildernesstravel.com.

This is a new adventure for 2023 and one that we are particularly excited about offering. However, as with all new departures, flexibility and a spirit of adventure are always appreciated! Activities are described in the itinerary but they can vary, sometimes considerably, depending on weather conditions, the group, and other factors.

REFERENCES

We'd be happy to put you in touch with a past client that has traveled with us on this or a similar trip.

ABOUT PRIVATE JOURNEYS

Wilderness Travel Private Journeys are designed for people who want to travel with their own small private group, but who still want to experience the same superb itinerary design, great accommodations, and signature quality of Wilderness Travel's escorted group trips. These Private Journeys allow you to choose your own dates and your traveling companions, yet still enjoy a guided adventure.

TOUCAN CLUB / TRAVEL AGENTS

Please note that travel agent commissions and Toucan Club discounts do not apply for our Private Journeys. However, your participation on these trips will count toward your Toucan discount on future departures of Wilderness Travel's regular expeditions. For more information regarding our Toucan Club bonus program, please visit our website at www.wildernesstravel.com/toucan.

VISIT OUR WEBSITE

At www.wildernesstravel.com, you can find out about added departures, last-minute deals, and special WT Expeditions that aren't listed in our catalog. You can also access a complete library of our detailed itineraries and browse the customized reading guides for each of our adventures.

Travel Notes



WILDERNESS TRAVEL HAS BEEN AWARDED:

Best Travel Specialists in the World: *Conde Nast Traveler*, 2024, 4-time winner

World's Best Tour Operators: *Travel + Leisure*, 11-time winner

Best Wildlife, Hiking & Walking Trips: *AFAR Magazine*, 3 years in a row

Best Adventure Travel Companies: *USA Today*

Trip of the Year: *Outside Magazine*, 9-time winner

50 Tours of a Lifetime: *National Geographic Traveler*, 9 years in a row

Best Adventure Travel Companies: *National Geographic Adventure*, 3-time winner

Please be advised that California has established a Travel Consumer Restitution Fund under the California Seller of Travel Law that took effect January 1, 1996. This fund is designed to protect consumers from unscrupulous practices by discount airfare ticket sellers or air charter operators. Unfortunately, this law does not cover non-California residents and, even in the case of California residents, it does not cover any foreign travel where the foreign "providers of transportation or travel services" are not in compliance with the Sellers of Travel Law (compliance being defined as registered as a Seller of Travel in California and a participant in the Travel Consumer Restitution Fund). Thus none of Wilderness Travel's tours qualify and we are required by law to advise each client that they are not covered by the California Travel Consumer Restitution Fund. California law requires sellers of travel to maintain a trust account or bond. This business has a trust account. California Seller of Travel #100769640

While as accurate as possible at the time of printing, this itinerary should be considered an approximate indication of the schedule and scope of activities and trip routing, rather than an inflexible schedule of events; it is subject to change due to circumstances beyond our control. This trip is subject to the Limitation of Liability and all the terms and conditions as detailed in the General Information section of the Wilderness Travel Catalog.

Revised: July 19, 2024 3:12 PM



1102 Ninth Street, Berkeley, CA 94710

800-368-2794 • 510-558-2488

www.wildernesstravel.com • info@wildernesstravel.com